

TOWNSHIP OF CAMBRIA  
CAMBRIA COUNTY  
PENNSYLVANIA

Road Docket  
02-03  
\$20 filing fee pd.

ORDINANCE NO. 172-2003

FILED FOR RECORD  
03 MAY 16 AM 11:06  
CLERK OF COURTS  
CAMBRIA COUNTY, PENNSYLVANIA

AN ORDINANCE LAYING OUT, OPENING AND ADOPTING AS PUBLIC ROADS/STREETS IN THE TOWNSHIP OF CAMBRIA, CAMBRIA COUNTY, PENNSYLVANIA, CERTAIN ROADS/STREETS TO BE DESIGNATED AS GATEWAY ROAD AND COMMERCE DRIVE, FIXING AND REGULATING THE WIDTH AND LENGTH THEREOF.

WHEREAS, the Cambria County Industrial Development Corporation has requested that certain roads/streets to be designated as Gateway Road and Commerce Drive which are wholly located within the Township of Cambria; be laid out, opened, and adopted as public roads/streets by the Township of Cambria; Cambria County, Pennsylvania; and,

WHEREAS, the aforesaid roads/streets have been built in accordance with the Township of Cambria's applicable Ordinances and regulations setting forth the specifications relative thereto; and,

WHEREAS, the Supervisors of the Township of Cambria, on behalf of said Township, understand that the hereinafter described roads/streets, i.e. Gateway Road and Commerce Drive, will be public roads/streets subject to public maintenance;

NOW, THEREFORE, BE IT ENACTED AND ORDAINED AND IT IS HEREBY ENACTED, AND ORDAINED BY THE BOARD OF SUPERVISORS OF THE TOWNSHIP OF CAMBRIA, ON BEHALF OF SAID TOWNSHIP, as follows:

SECTION 1: The roads/streets to be known as Gateway Road and Commerce Drive, the descriptions of which are set forth in Section 2 hereof, are designated as Gateway Road and Commerce Drive, and are hereby accepted, laid out,

opened and ordained as public roads/streets of the Township of Cambria, County of Cambria, and State of Pennsylvania.

**SECTION 2:** The description of the roads/streets designated and known as Gateway Road and Commerce Drive located in the Township of Cambria, County of Cambria and State of Pennsylvania (South Park Complex - Phase I Subdivision) are described as follows:

**LEGAL DESCRIPTION - GATEWAY ROAD AND COMMERCE DRIVE:**

BEGINNING at an extant iron pin with aluminum alloy cap at the intersection of the westerly right of way line of Gateway Road and the southerly line of land of Cambria County Industrial Development Corporation occupied by B&W Road;

Thence, along said southerly line, South Eighty-Four degrees Forty-Four minutes Thirty-Nine seconds East (S 84 degrees 44' 39" E), a distance of One Hundred Seventy and Five hundredths feet (170.05') to an iron pin with aluminum cap;

Thence along land of Stephen F. Persio, Deborah A. Maruca, Linda M. Link, Kevin D. Persio and Gregory A. Persio of which this is a part, the following two (2) courses:

1) By a non-tangential curve to the left having a radius of Fifty and Zero hundredths feet (50.00'), a chord bearing South Fifty degrees Fifty-Five minutes Fifty-Three seconds West (S 50 degrees 55' 53" W) for a distance of Sixty Nine and Eighty-Seven hundredths feet (69.87') and an arc length of Seventy-Seven and Thirty-Six hundredths feet (77.36') to an iron pin with aluminum cap and

2) South Six degrees Thirty-Six minutes Twenty-Four seconds West (S 06 degrees 36' 24" W), a distance of Six Hundred Ninety and Nineteen hundredths feet (690.19') to an iron pin with aluminum cap;

Thence, along right of way lines of roads (Gateway Road and Commerce Drive) shown on the Cambria County Industrial Development Corporation South Park Complex - Phase 1 Subdivision Plan recorded in Cambria County Plat Book Volume 7 at Page 992, the following twenty-two (22) courses.

1) South Six degrees Thirty-Six minutes Twenty-Four seconds West (S 06 degrees 36' 24" W) a distance of Two Hundred Ninety-Four and Eighty-Two hundredths feet (294.82') to a point of curvature,

Road Docket -  
#2-03

- 2) By a curve to the left having a radius of Fifty and Zero hundredths feet (50.00'), a chord bearing South Thirty-Eight degrees Twenty-Three minutes Thirty-Six seconds East (S 38 degrees 23' 36" E), a distance of Seventy and Seventy-One hundredths feet (70.71') and an arc length of Seventy-Eight and Fifty-Four hundredths feet (78.54'),
- 3). Thence, South Six degrees Thirty-Six minutes Twenty-Four seconds West (S 06 degrees 36' 24" W), a distance of Seventy and Zero hundredths feet (70.00'),
- 4). North Eighty-Three degrees Twenty-Three minutes Thirty-Six seconds West (N 83 degrees 23' 36" W), a distance of Nine Hundred Eleven and Sixteen hundredths feet (911.16') to a point of curvature,
- 5). By a curve to the left having a radius of Two Hundred Forty-Five and Zero hundredths feet (245.00'), a chord bearing South Fifty-One degrees Thirty-Seven minutes Twenty seconds West (S 51 degrees 37' 20" W) for a distance of Three Hundred Forty-Six and Thirty-Nine hundredths feet (346.39') and an arc length of Three Hundred Eighty-Four and Seventy-One hundredths feet (384.71') to a point of tangency,
- 6). South Six degrees Thirty-Eight minutes Seventeen seconds West (S 06 degrees 38' 17" W), a distance of One Hundred Seventy and Zero hundredths feet (170.00') to a point of curvature,
- 7). By a curve to the left having a radius of Two Hundred Forty-Five and Zero hundredths feet (245.00'), a chord bearing South Thirty-Eight degrees Twenty-Two minutes Forty seconds East (S 38 degrees 22' 40" E), a distance of Three Hundred Forty-Six and Fifty-Eight hundredths feet (346.58') and an arc length of Three Hundred Eighty-Four and Ninety-Eight hundredths feet (384.98') to a point of tangency.
- 8). South Eighty-Three degrees Twenty-Three minutes Thirty-Six seconds East (S 83 degrees 23' 36" E), a distance of Seven Hundred Forty-Six and Thirty-Eight hundredths feet (746.38') to a point of curvature,
- 9). By a curve to the left having a radius of Eighty and Zero hundredths feet (80.00'), a chord bearing North Seventy-Four degrees Two minutes Thirty-Three seconds East (N 74 degrees 02' 33" E) for a distance of Sixty-One and Thirty-Nine hundredths feet (61.39') and an arc length of Sixty-Three and One hundredth feet (63.01') to a point of compound curvature,
- 10). By a curve to the right having a radius of Eighty-Three and Zero hundredths feet (83.00'), a chord bearing South Seventy-Three degrees Twenty-Five minutes Forty-One seconds East (S 73 degrees 25' 41" E), a distance of One Hundred Thirty-Six and Thirteen hundredths feet (136.13') and an arc length of One Hundred Fifty-Nine and Sixty-Two hundredths feet (159.62'),

- 11). South Eighty-Three degrees Twenty-Three minutes Thirty-Six seconds East (S 83 degrees 23' 36" E) a distance of Twenty and Zero hundredths feet (20.00') to a point of curvature,
- 12). Thence, South Six degrees Thirty-Six minutes Twenty-Four seconds West (S 06 degrees 36' 24" W), a distance of Seventy and Zero hundredths feet (70.00'),
- 13). North Eighty-Three degrees Twenty-Three minutes Thirty-Six seconds West (N 83 degrees 23' 36" W), a distance of Twenty and Zero hundredths feet (20.00'),
- 14). By a non-tangential curve to the right having a radius of Eighty-Three and Zero hundredths feet (83.00'), a chord bearing South Eighty-Six degrees Thirty Eight minutes Twenty-Nine seconds West (S 86 degrees 38' 29" W) for a distance of One Hundred Thirty-Six and Thirteen hundredths feet (136.13') and an arc length of one Hundred Fifty-Nine and Sixty-Two hundredths feet (159.62') to a point of compound curvature,
- 15). By a curve to the left having a radius of Eighty and Zero hundredths feet (80.00'), a chord bearing North Sixty degrees Forty-Nine minutes Forty-Five seconds West (N 60 degrees 49' 45" W), a distance of Sixty-One and Thirty-Nine hundredths feet (61.39') and an arc length of Sixty-Three and One hundredths feet (63.01') to a point of tangency,
- 16). North Eighty-Three degrees Twenty-Three minutes Thirty-Six seconds West (N 83 degrees 23' 36" W), a distance of Seven Hundred Forty-Six and Thirty-Eight hundredths feet (746.38') to a point of curvature,
- 17). By a curve to the right having a radius of Three Hundred Fifteen and Zero hundredths feet (315.00'), a chord bearing North Thirty-Eight degrees Twenty-Two minutes Forty seconds West (N 38 degrees 22' 40" West) for a distance of Four Hundred Forty-Five and Sixty hundredths feet (445.60') and an arc length of Four Hundred Ninety-Four and Ninety-Seven hundredths feet (494.97') to a point of tangency,
- 18). North Six degrees Thirty-Eight minutes Seventeen seconds East (N 06 degrees 38' 17" E), a distance of One Hundred Seventy and Zero hundredths feet (170.00') to a point of curvature,
- 19). By a curve to the right having a radius of Three Hundred Fifteen and Zero hundredths feet (315.00'), a chord bearing North Fifty-One degrees Thirty-Seven minutes Twenty seconds East (N 51 degrees 37' 20" E), a distance of Four hundred Forty-Five and Thirty-Six hundredths feet (445.36') and an arc length of Four Hundred Ninety-Four and Sixty-Three hundredths feet (494.63') to a point of tangency,
- 20). South Eighty-Three degrees Twenty-Three minutes Thirty-Six seconds East (S 83 degrees 23' 36" E), a distance of Seven Hundred Forty-One and Sixteen hundredths feet (741.16') to a point of curvature,

SECTION 5: Nothing contained herein nor shall the Township in  
in laying out, opening, adopting and ordaining the aforesaid Gateway Road and  
Commerce Drive as public roads/streets of the Township, be construed as granting to the  
Township ownership of any stormwater management, ditches, drains, pipes, etc. located  
within the rights-of-way as to said roads/streets; nor shall maintenance of same be  
construed to be the responsibility of the Township of Cambria.

ENACTED AND ORDAINED by the Board of Supervisors of the Township of  
Cambria on behalf of said Township, this 28 day of April, 2003.

TOWNSHIP OF CAMBRIA

BY:

*Robert Sharp*

Chairman Of Board Of Supervisors

*Laura J. Hoover*

Supervisor

Supervisor

ATTEST:

*Norma Cicero*

Secretary

(SEAL)

I hereby certify this to be a true and exact copy of Ordinance No. 2003-172, passed by the  
Board of Supervisors of the Township of Cambria on this 28th. day of April 2003.

*Norma Cicero*

Norma Cicero, Secretary and Treasurer

U.S. RTE. 219

Road Docket # 02-03

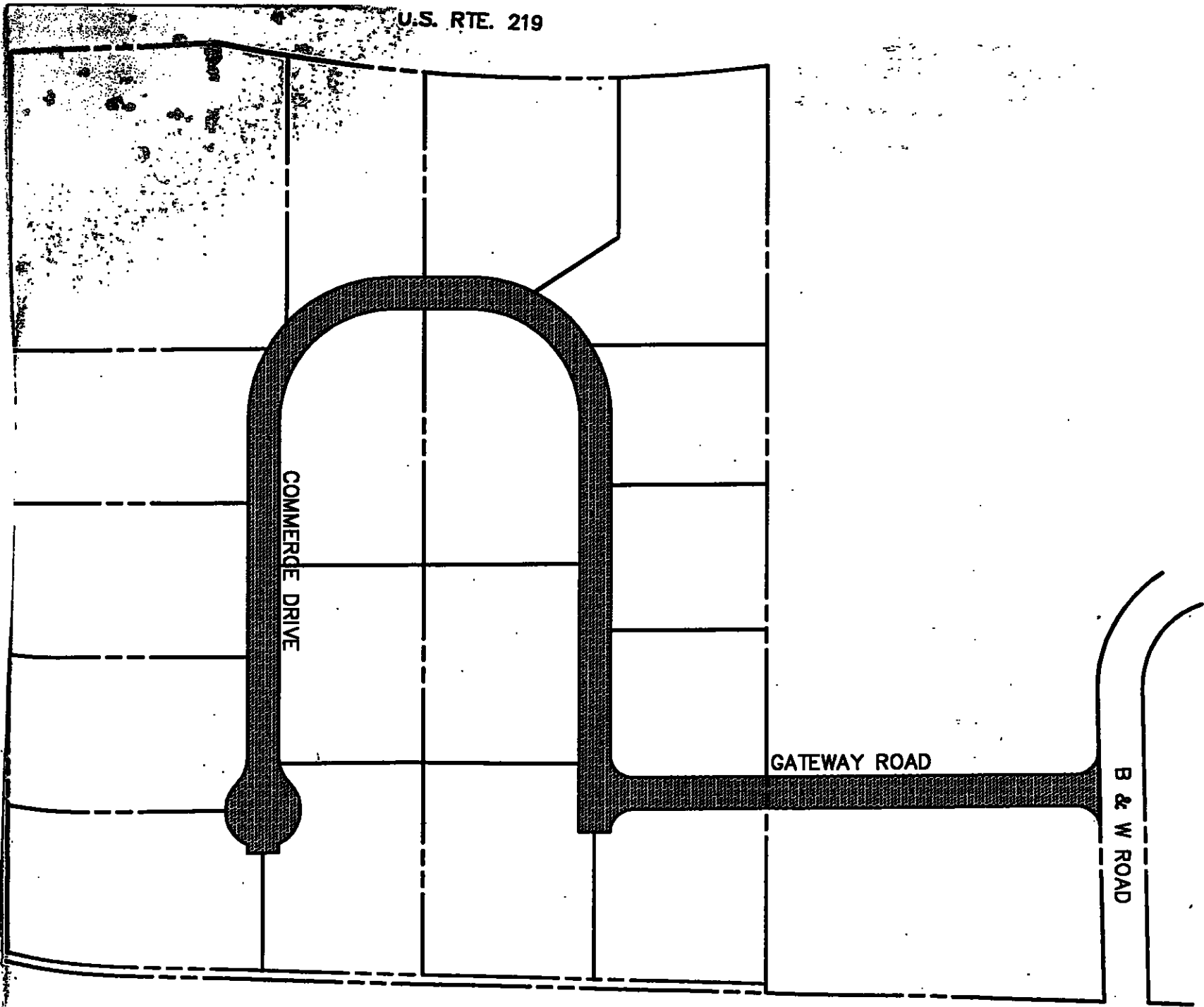

S.R. 0160

DEDICATION TO TOWNSHIP OF CAMBRIA

