

3/10/92 15.00 filing fee

No. 03-92

TOWNSHIP OF CAMBRIA
CAMBRIA COUNTY
PENNSYLVANIA

MAR 10 12 14 PM '92
FILED
CLERK OF COURTS
CAMBRIA CO PA

ORDINANCE NO. 117

AN ORDINANCE VACATING A PUBLIC ROAD KNOWN AS
SERVICE ROAD #1 (TR 793), LOCATED IN THE
TOWNSHIP OF CAMBRIA, CAMBRIA COUNTY, PENNSYLVANIA

WHEREAS, the Pennsylvania Department of Transportation had constructed certain Service Roads relative to the construction of U.S. Route 219 running from SR 4005 and known as Service Road #1 (TR 793) and Service Road #2 (TR 794) located in the Township of Cambria, Cambria County, Pennsylvania; and,

WHEREAS, the Act of May 29, 1945, P.L. 1108, Section 12, recites: "Local service highways constructed under authority of this Act shall, upon completion of construction, be maintained by and at the expense of the political subdivision in which they are located"; and,

WHEREAS, the Board of Supervisors of the Township of Cambria, pursuant to the Second Class Township Code (53 P.S. 66101) and after hearing from the effected property owners, has determined that Service Road #1 (TR 793) should be vacated and no longer deemed to be a public road of the Township of Cambria, Cambria County, Pennsylvania, which road would, if it remained a public road, be subject to maintenance by the said Township.

THEREFORE, it is hereby ORDAINED AND ENACTED by the Board of Supervisors of the Township of Cambria, on behalf of the Township of Cambria, as follows:

SECTION 1: A road beginning on State Route 4005 (the Ebensburg/Colver Road) and running in a generally southwesterly

direction from State Route 4005 (the Ebensburg/Colver Road) for approximately .11 of a mile and known as Service Road No. 1 (TR 793), is hereby vacated as a public road and shall not be considered a public road of the Township of Cambria, Cambria County, Pennsylvania, subject to the Township's maintenance.

SECTION 2: The aforesaid Service Road #1 (TR 793) being approximately .11 of a mile is to be removed as a public road from the Township of Cambria's road system so that the Township will not, in the future, have any duty as to maintenance and/or repair or same nor will the Township receive any State and/or Federal funds relative to same.

SECTION 3: The Service Road to be vacated is shown on Exhibit "A" as Service Road #1 (TR 793), which Exhibit is attached hereto and made a part hereof.

SECTION 4: The Secretary of the Township of Cambria is directed to file a copy of this Ordinance together with the necessary drafts and surveys relative to Service Road #1 with the Office of the Clerk of Court's of Cambria County, Pennsylvania and with all other appropriate officials of the Commonwealth of Pennsylvania.

SECTION 5: Service Road #1 (TR 793) and Service Road #2 (TR 794) are shown on maps heretofore recorded in the Recorder of Deed's Office in and for Cambria County, Pennsylvania, however, Service Road #1 (TR 793) is hereby vacated.

ENACTED AND ORDAINED by the Board of Supervisors of the Township of Cambria, Cambria County, Pennsylvania, this _____ day of _____, 1992.

TOWNSHIP OF CAMBRIA

BY:

Fred Sauger
Fred Sauger, Chairman Of The Board Of
Supervisors

Robert Shook
Robert Shook, Supervisor

David Hoover
David Hoover, Supervisor

ATTEST:

Norma Zimmerman
(Secretary)

I hereby certify this to be a true and exact copy of Ordinance No. 117, whereby the Township of Cambria vacated a public road known as Service Road #1 at the meeting of Feb. 10, 1992 of the Board of Supervisors of Cambria Township, Cambria County, Penna.

Norma Zimmerman
Norma Zimmerman
Secretary-Treasurer

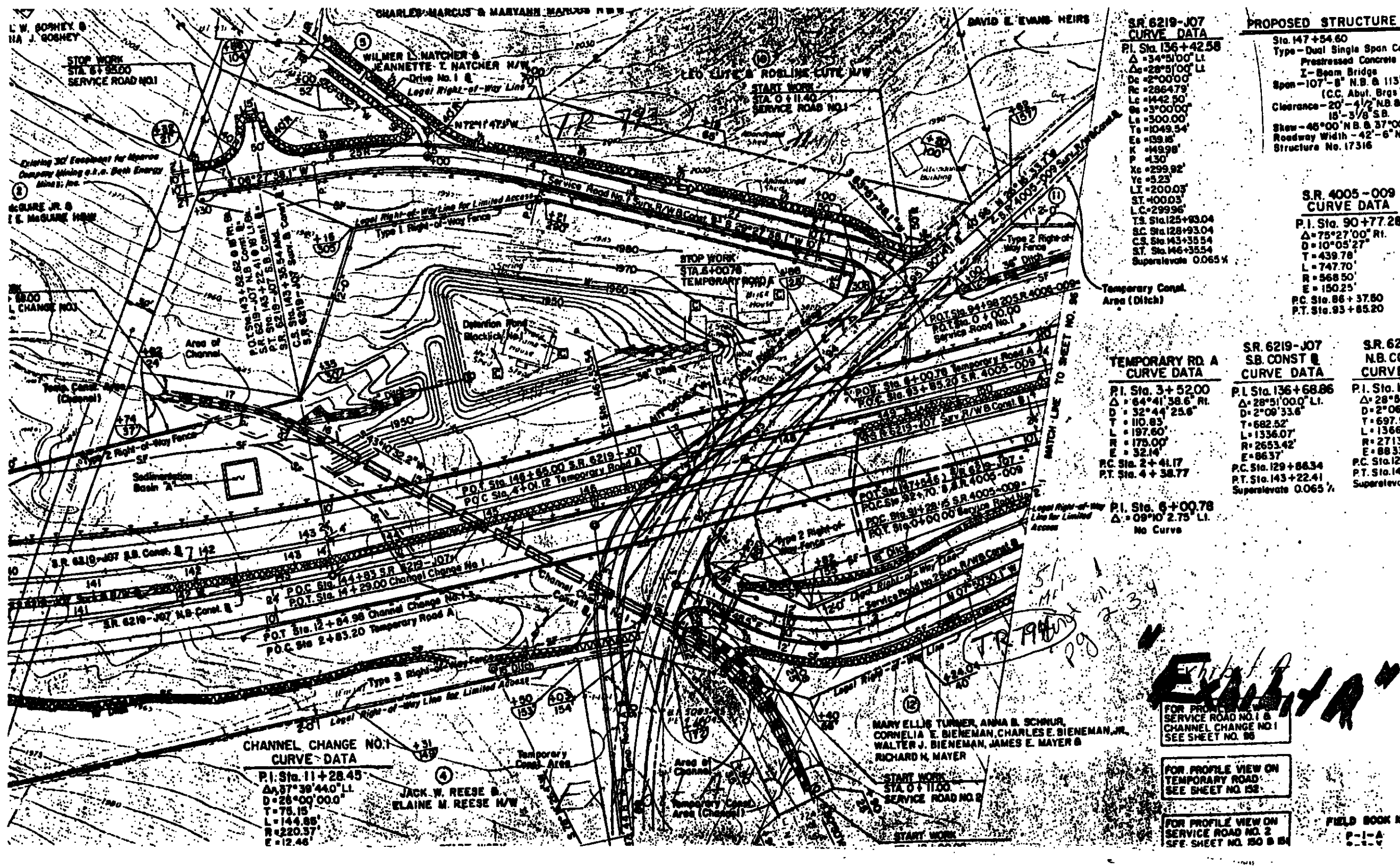

SR 6219-J07 CURVE DATA

PI Sta. 136+42.58
$\Delta = 34^{\circ}51'00''$ LI
$\Delta c = 28^{\circ}51'00''$ LI
Dc = 2^{\circ}00'00''
Rc = 2864.79'
Lc = 1442.50'
Gc = 3^{\circ}00'00''
Ls = 300.00'
Ts = 1049.54'
Es = 439.16'
K = 149.98'
P = 1.30'
Xc = 299.92'
Yc = 5.23'
LI = 200.03'
ST = 400.03'
L.C. = 299.96'
T.S. Sta. 125+93.04
S.C. Sta. 128+93.04
C.S. Sta. 143+35.54
S.T. Sta. 146+35.54
Superelevate 0.065 %

PROPOSED STRUCTURE I

Sta. 147+54.60
Type - Dual Single Span Con.
Prestressed Concrete
I-Beam Bridge
Span - 107' - 8" N.B. & 113' - (C.C. Abut. Brgs.)
Clearance - 20' - 4 1/2" N.B. & 18' - 3 1/8" S.B.
Skew - 45^{\circ}00' N.B. & 37^{\circ}00'
Roadway Width - 42' - 6" N.B.
Structure No. 17316

S.R. 4005 - 009 CURVE DATA

P.I. Sta. 90+77.28
$\Delta = 75^{\circ}27'00''$ RI
D = 10^{\circ}05'27''
T = 439.78'
L = 747.70'
R = 968.50'
E = 150.25'
P.C. Sta. 86+37.80
P.T. Sta. 93+85.20

Temporary Canal Area (Ditch)

TEMPORARY RD. A CURVE DATA

P.I. Sta. 3+52.00
$\Delta = 64^{\circ}41'38.6''$ RI
D = 32^{\circ}44'25.6''
T = 110.85'
L = 197.60'
R = 175.00'
E = 32.14'
P.C. Sta. 2+41.17
P.T. Sta. 4+38.77

S.R. 6219-J07 SB CONST CURVE DATA

P.I. Sta. 136+68.86
$\Delta = 28^{\circ}51'00''$ LI
D = 2^{\circ}09'33.6''
T = 682.52'
L = 1336.07'
R = 2653.42'
E = 86.37'
P.C. Sta. 129+86.34
P.T. Sta. 143+22.41
Superelevate 0.065 %

S.R. 6219-NB CONST CURVE DATA

P.I. Sta. 137
$\Delta = 28^{\circ}51'00''$ LI
D = 2^{\circ}06'4''
T = 697.9'
L = 1366.2'
R = 2713.4'
E = 88.33'
P.C. Sta. 128
P.T. Sta. 142
Superelevate

P.I. Sta. 6+00.78
 $\Delta = 09^{\circ}10'2.75''$ LI
 No Curve

CHANNEL CHANGE NO. 1 CURVE DATA

P.I. Sta. 11+28.45
$\Delta = 37^{\circ}39'44.0''$ LI
D = 26^{\circ}00'00.0''
T = 78.15'
L = 144.85'
R = 220.37'
E = 12.46'

JACK W. REESE & ELAINE M. REESE N/W

MARY ELLIS TURNER, ANNA B. SCHNUR, CORNELIA E. BIENEMAN, CHARLES E. BIENEMAN, JR., WALTER J. BIENEMAN, JAMES E. MAYER & RICHARD H. MAYER

FOR PROFILE VIEW ON SERVICE ROAD NO. 1 & CHANNEL CHANGE NO. 1 SEE SHEET NO. 88

FOR PROFILE VIEW ON TEMPORARY ROAD SEE SHEET NO. 152

FOR PROFILE VIEW ON SERVICE ROAD NO. 2 SEE SHEET NO. 150 & 151

FIELD BOOK NO. P-1-A 6-1-4

Exhibit A

18" Cherry 6" Sumac

S.C. Sta. 160+15.44

E 1723.750
N 428.000

E 1723.750
N 427.000

EVANS

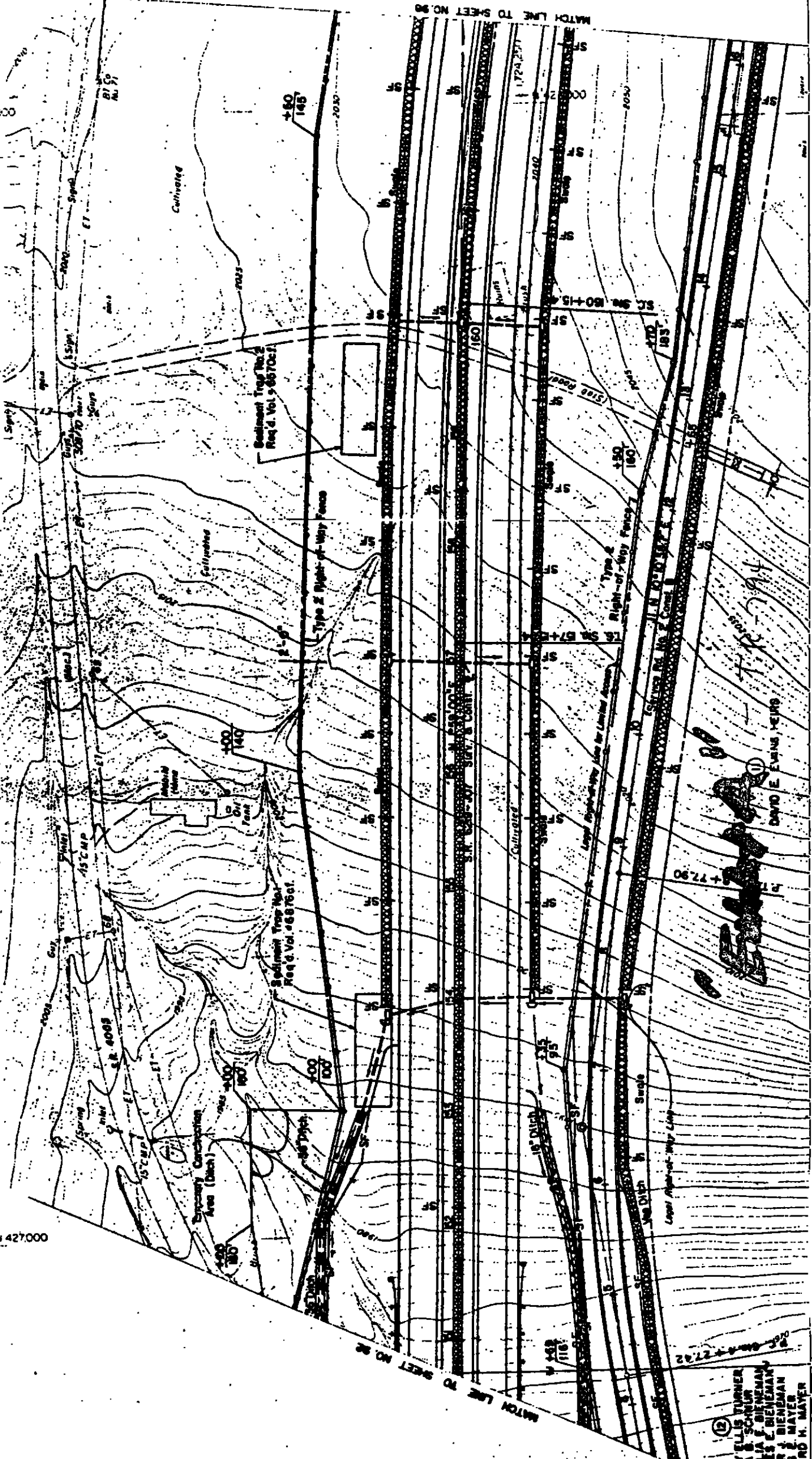

MATCH LINE TO SHEET NO. 98

MATCH LINE TO SHEET NO. 99

MARY ELLIS TURNER
 ANNA B. SCHMIDT
 CORNELIA E. BIEBMAN
 CHARLES J. BIEBMAN
 WALTER J. BIEBMAN
 JAMES E. MAYER
 RICHARD H. MAYER

DAVID E. EVANS HEIRS

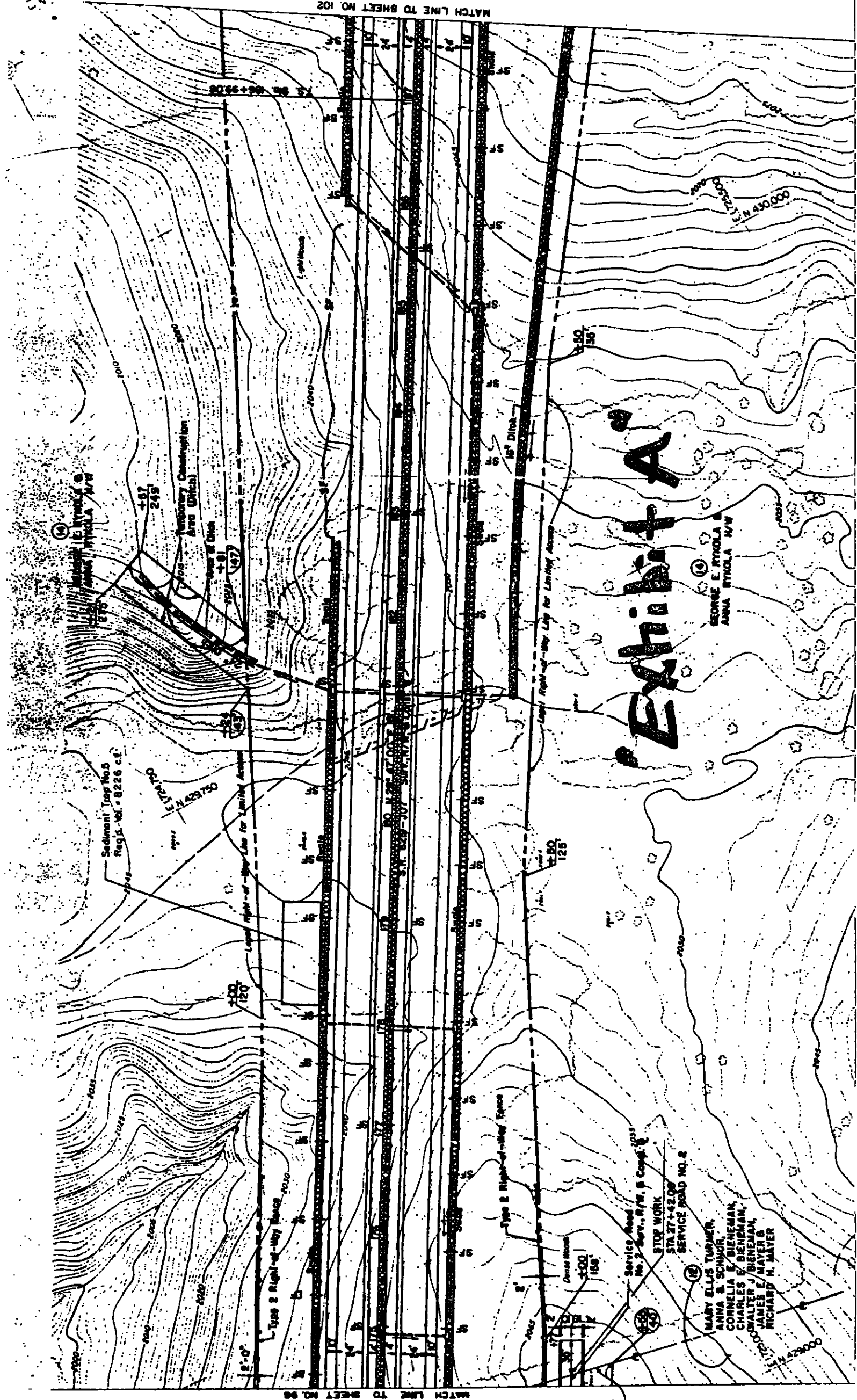

EXHIBIT A

(10) GEORGE E. RYKOLA &
 ANNA RYKOLA N/W

(11) MARY ELLIS TURNER,
 ANNA B. SCHMIDT,
 CORNELIA E. BIENEMAN,
 CHARLES E. BIENEMAN,
 WALTER J. BIENEMAN,
 JAMES E. MAYER S,
 RICHARD H. MAYER

Service Road
 No. 2 - Surv. R/W, S. Cont'd. 1935
 STOP WORK
 STA 27+42.00
 SERVICE ROAD NO. 2