

R.O. #5 June 1953

Exhibit "A"

Not Microfilmed

**DRAWING SHOWING
ABANDONED & RELOCATED PORTION
of
ROUTE 11054 SECTION 3
Patton Borough - Elder & Chest Townships
CAMBRIA COUNTY
District 9**

Scale: 1" = 100'

Plan approved by the Governor May 3, 1950

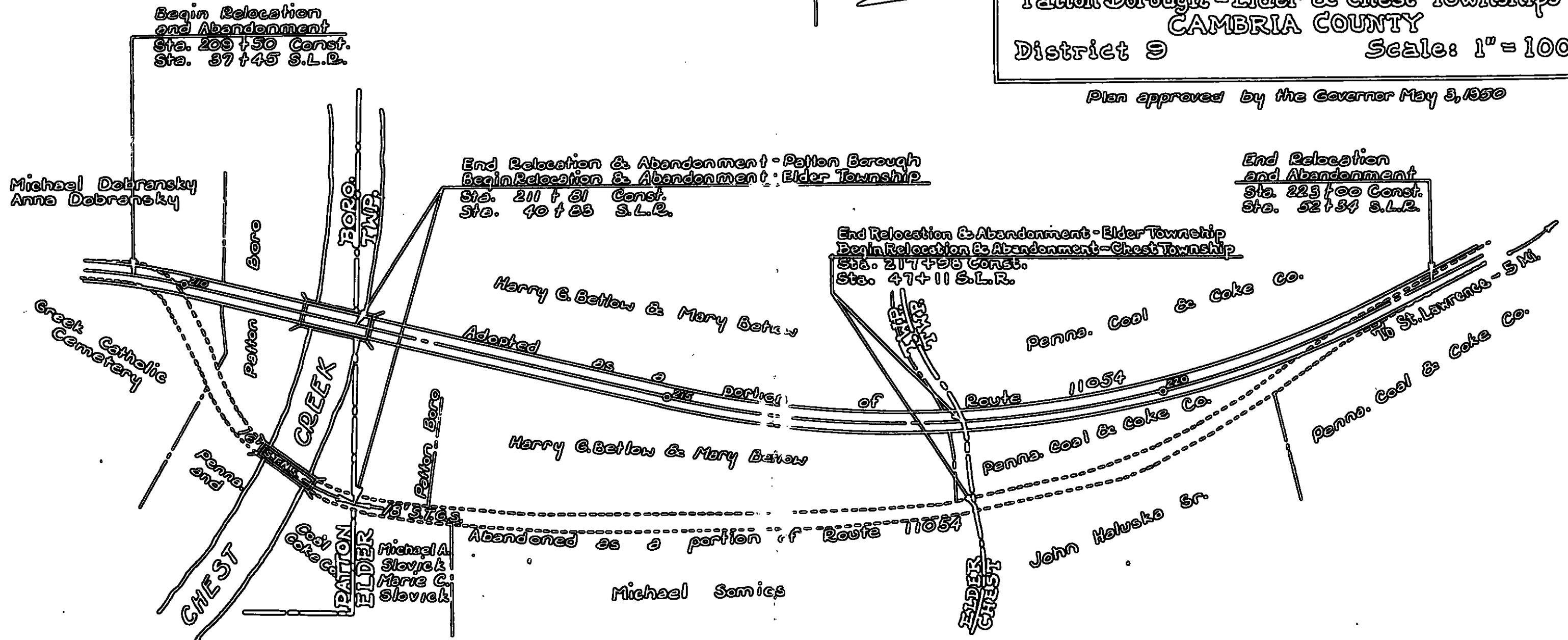

TABULATION OF CHANGES BY RELOCATION

Subdivision	Stations	RELOCATION						ABANDONED					
		Improved		Unimproved		Total		Improved		Unimproved		Total	
		Ft.	Mi.	Ft.	Mi.	Ft.	Mi.	Ft.	Mi.	Ft.	Mi.	Ft.	Mi.
Patton Borough	209+50 = 211+81 Const. 37+45 = 40+83 S.L.R.	231	0.04233			231	0.04233	333	0.0640			333	0.0640
Elder Township	211+81 = 217+93 Const. 40+83 = 47+11 S.L.R.	617	0.11168			617	0.11168	628	0.1189			628	0.1189
Chest Township	217+93 = 223+00 Const. 47+11 = 52+34 S.L.R.	502	0.09511			502	0.09511	523	0.0991			523	0.0991

IN THE COURT OF QUARTER SESSIONS OF CAMBRIA COUNTY,
PENNSYLVANIA

IN THE MATTER OF THE REPORT OF THE
SUPERVISORS OF ELDER TOWNSHIP, RELATING
TO THE VACATION OF ROUTE NO. 11054 IN
SAID TOWNSHIP

No. 2 JUNE SESSIONS 1953
Road Docket Vol 9 Page 252

In accordance with the provisions of Article XI of the Act of May 24, 1951, P. L. 370, s 13, et seq., as amended, 53 P. S. 19093 - 1101 et seq., Bernard Thomas, Michael Novak and Jerome Holtz, Supervisors of the Township of Elder, County of Cambria, and State of Pennsylvania, hereby make the following report:

-1-

That Michael Novak and Jerome Holtz are duly elected, qualified and active supervisors of the said Township of Elder, and that Bernard Thomas is a duly appointed, qualified and active supervisor, having been appointed March 3, 1953 to fulfill the unexpired term of Charles Thomas, deceased.

-2-

That Route 11054, in said Township, commences at the Patton Borough-Elder Township line at State Highway Station 40 + 83 and extends for 0.1189 miles to the Elder Township-Chest Township line at State Highway Station 47 + 11. That it is desired to vacate said road because of public convenience. That a copy of a survey of the said road is hereby attached marked Exhibit A, and made a part hereof.

-3-

That the owners of real estate affected by the abandonment and vacating of said Route 11054 are listed as follows: Harry G. Betlow, Mary Betlow, Michael A. Slovick, Marie C. Slovick, Michael J. Somics Estate, Helen M. Peterson, Adm^r.

-4-

That the above named persons were each served on the 14th day of March, 1953, with written notice to the effect that the Supervisors of said Township of Elder, would hold a meeting on the 24th day of March, 1953 at 7:00 o'clock P. M. at St. Boniface School Building at St. Boniface, Pennsylvania, to consider the matter of vacating the said Route 11054. The Notices together with the several Acceptances of Service are hereto attached marked Exhibits B, C, D, E and F, and made a part hereof.

-5-

That the Township of Elder was released and forever discharged from any and all claims to damages caused by said vacation of a portion of Route 11054 as is shown by the written release of damages sealed and filed by the aforesaid owners of the real estate. Said Release of Damages is hereto attached, marked Exhibit G and made a part hereof.

-6-

That pursuant to said notice, the Supervisors of the said Township of Elder held the said meeting at the time and place aforesaid at which meeting the said supervisors, in the interest of public convenience, passed an ordinance vacating the said Route 11054. Certified copy of the said ordinance is hereto attached, marked Exhibit H and made a part hereof.

Bernard Thomas

Michael Novak

Jerome Holtz

Supervisors of Elder Township

Exhibit "a" is a blue map
and will be done separately.

NOTICE

IN THE MATTER OF THE VACATION
OF A PORTION OF ROAD WHOLLY IN
ELDER TOWNSHIP, CAMBRIA
COUNTY, PENNSYLVANIA

NOTICE IS HEREBY GIVEN that the Supervisors of Elder Town-
ship. will hold a meeting on the 24 day of March at 7 o'clock
in the St. Boniface School Building at St. Boniface, Pennsylvania, when and
where all parties interested may be heard, to consider the matter of vacating
State Highway Route 11054 within said Township of Elder. Said road was aban-
doned by the Commonwealth of Pennsylvania as part of the State Highway Sys-
tem because of the relocation and construction of a new portion of State High-
way Route No. 11054 by the Department of Highways.

THE said abandoned portion of State Highway Route No. 11054 to
be considered at the aforementioned meeting is described as follows:

BEGINNING at State Highway Station 40+ 83 on
State Highway Route No. 11054 at the line of the Patton
Borough in the Township of Elder, thence following the
old or abandoned portion of said Route No. 11054, a
distance of 628 feet or 0.1189 miles to the line of Elder
Township-Chest Township at Station 47+ 11.

Miss Lucy Kibler
Secretary of the Board of Supervisors
of Elder Township

ACCEPTANCE OF SERVICE

AND NOW, this 24 day of March I HEREBY
ACCEPT SERVICE OF THE ABOVE NOTICE.

Harry J. Bellon

NOTICE

IN THE MATTER OF THE VACATION
OF A PORTION OF ROAD WHOLLY IN
ELDER TOWNSHIP, CAMBRIA
COUNTY, PENNSYLVANIA

NOTICE IS HEREBY GIVEN that the Supervisors of Elder Town-
ship, will hold a meeting on the 24 day of March at 7 o'clock
in the St. Boniface School Building at St. Boniface, Pennsylvania, when and
where all parties interested may be heard, to consider the matter of vacating
State Highway Route 11054 within said Township of Elder. Said road was aban-
doned by the Commonwealth of Pennsylvania as part of the State Highway Sys-
tem because of the relocation and construction of a new portion of State High-
way Route No. 11054 by the Department of Highways.

THE said abandoned portion of State Highway Route No. 11054 to
be considered at the aforementioned meeting is described as follows:

BEGINNING at State Highway Station 40+ 83 on
State Highway Route No. 11054 at the line of the Patton
Borough in the Township of Elder; thence following the
old or abandoned portion of said Route No. 11054, a
distance of 628 feet or 0.1189 miles to the line of Elder
Township-Chest Township at Station 47+ 11.

Miss Lucy Kibler
Secretary of the Board of Supervisors
of Elder Township

ACCEPTANCE OF SERVICE

AND NOW, this 24 day of March I HEREBY
ACCEPT SERVICE OF THE ABOVE NOTICE.

Mary E. Betlow

NOTICE

IN THE MATTER OF THE VACATION
OF A PORTION OF ROAD WHOLLY IN
ELDER TOWNSHIP, CAMBRIA
COUNTY, PENNSYLVANIA

NOTICE IS HEREBY GIVEN that the Supervisors of Elder Town-
ship, will hold a meeting on the 24 day of March at 7 o'clock
in the St. Boniface School Building at St. Boniface, Pennsylvania, when and
where all parties interested may be heard, to consider the matter of vacating
State Highway Route 11054 within said Township of Elder. Said road was aban-
doned by the Commonwealth of Pennsylvania as part of the State Highway Sys-
tem because of the relocation and construction of a new portion of State High-
way Route No. 11056 by the Department of Highways.

THE said abandoned portion of State Highway Route No. 11054 to
be considered at the aforementioned meeting is described as follows:

BEGINNING at State Highway Station 40 & 83 on
State Highway Route No. 11054 at the line of the Patton
Berough in the Township of Elder, thence following the
old or abandoned portion of said Route No. 11054, a
distance of 628 feet or 0.1189 miles to the line of Elder
Township-Chest Township at Station 47 & 11.

Miss Lucy Kibler
Secretary of the Board of Supervisors
of Elder Township

ACCEPTANCE OF SERVICE

AND NOW, this 14 day of March I HEREBY
ACCEPT SERVICE OF THE ABOVE NOTICE.

Michael Slusich

NOTICE

IN THE MATTER OF THE VACATION
OF A PORTION OF ROAD WHOLLY IN
ELDER TOWNSHIP, CAMBRIA
COUNTY, PENNSYLVANIA

NOTICE IS HEREBY GIVEN that the Supervisors of Elder Town-
ship, will hold a meeting on the 24 day of March at 7 o'clock
in the St. Boniface School Building at St. Boniface, Pennsylvania, when and
where all parties interested may be heard, to consider the matter of vacating
State Highway Route 11054 within said Township of Elder. Said road was aban-
doned by the Commonwealth of Pennsylvania as part of the State Highway Sys-
tem because of the relocation and construction of a new portion of State High-
way Route No. 11054 by the Department of Highways.

THE said abandoned portion of State Highway Route No. 11054 to
be considered at the aforementioned meeting is described as follows:

BEGINNING at State Highway Station 40+ 83 on
State Highway Route No. 11054 at the line of the Patton
Borough in the Township of Elder; thence following the
old or abandoned portion of said Route No. 11054, a
distance of 620 feet or 0.1169 miles to the line of Elder
Township-Chest Township at Station 47+ 11.

Miss Lucy Kibler
Secretary of the Board of Supervisors
of Elder Township

ACCEPTANCE OF SERVICE

AND NOW, this 24 day of March I HEREBY
ACCEPT SERVICE OF THE ABOVE NOTICE.

Mr. Marie Slovick

NOTICE

IN THE MATTER OF THE VACATION
OF A PORTION OF ROAD WHOLLY IN
ELDER TOWNSHIP, CAMBRIA
COUNTY, PENNSYLVANIA.

NOTICE IS HEREBY GIVEN that the Supervisors of Elder Town-
ship, will hold a meeting on the 24 day of March at 7 o'clock
in the St. Boniface School Building at St. Boniface, Pennsylvania, when and
where all parties interested may be heard, to consider the matter of vacating
State Highway Route 11054 within said Township of Elder. Said road was aban-
doned by the Commonwealth of Pennsylvania as part of the State Highway Sys-
tem because of the relocation and construction of a new portion of State High-
way Route No. 11054 by the Department of Highways.

THE said abandoned portion of State Highway Route No. 11054 to
be considered at the aforesaid meeting is described as follows:

BEGINNING at State Highway Station 60 + 03 on State
Highway Route No. 11054 at the line of the Patten Borough in the
Township of Elder; thence following the old or abandoned portion
of said Route No. 11054, a distance of 628 feet or 0.1199 miles to
the line of Elder Township - Chest Township at Station 47 + 11.

Miss Lucy Kibler
Secretary of the Board of Supervisors
of Elder Township

ACCEPTANCE OF SERVICE

AND NOW, this 14 day of March, I HEREBY ACCEPT
SERVICE OF THE ABOVE NOTICE.

Michael J. Sarnice, Est.
Helen M. Peterson
admf

RELEASE OF DAMAGES

THE UNDERSIGNED, abutting property owners, of the land herein described, for and in consideration of the sum of One (\$1.00) Dollar, the receipt whereof is hereby acknowledged, do hereby remise, release and forever discharge the Township of Elder, County of Cambria and State of Pennsylvania from any and all claims to damages caused by the vacation of a portion of road situate in said Township of Elder, County of Cambria and State of Pennsylvania, described as follows:

BEGINNING at State Highway Station 40 + 83 on State Highway Route No. 11054 at the line of the Patton Borough in the Township of Elder; thence following the old or abandoned portion of said Route No. 11054, a distance of 628 feet or 0.1189 miles to the line of Elder Township - Chest Township at Station 47 + 11.

IN WITNESS WHEREOF, the said parties have hereunto set their hands and seals the 14 day of March, 1953.

Michael Slavick (SEAL)

Mrs. Marie Slavick (SEAL)

Harry S. Betlow (SEAL)

Mary E. Betlow (SEAL)

Michael J. Seines (SEAL) ^{Est}

Helen M. Peterson adm.

ORDINANCE NO. 2.

AN ORDINANCE TO VACATE A ROAD KNOWN AS STATE HIGHWAY ROUTE 11054, LEADING FROM PATTON BOROUGH FOR A DISTANCE OF 0.1189 MILES TO THE ELDER TOWNSHIP-CHEST TOWNSHIP LINE.

WHEREAS, State Highway Route 11054 is a part of the road system of Elder Township and leads from Patton Borough for a distance of 0.1189 miles to the Elder Township-Chest Township Line.

WHEREAS Route No. 11054 was abandoned by the Commonwealth of Pennsylvania as part of the State Highway System because of relocation and construction of a new portion of said State Highway Route No. 11054 by the Department of Highways and is not necessary or needed as a township road, and, in the interest of public convenience, the said supervisors have decided to vacate, by ordinance, the said Route 11054 herein described.

NOW THEREFORE, Be It Ordained and enacted by the Supervisors of Elder Township, and it is hereby ordained and enacted by authority of the same:

SECTION. 1

THAT in the judgment of the Supervisors, for and in the interest of public convenience, the following described road be and the same is hereby vacated:

BEGINNING at State Highway Station 40 + 83 on State Highway Route No. 11054 at the line of the Patton Borough in the Township of Elder; thence following the old or abandoned portion of said Route No. 11054, a distance of 628 feet or 0.1189 miles to the line of Elder Township-Chest Township at Station 47 + 11.

SECTION 2.

THAT the Township Solicitor be and hereby is authorized and directed to file a certified copy of the Ordinance in the office of the Clerk of

Courts of Quarter Sessions of Cambria County, State of Pennsylvania, together with the name of the owners of property affected, a draft and survey of the road vacated, and a report of the proceedings relating to the vacation of the road hereinabove described.

SECTION 3.

ALL ordinances or parts of ordinances inconsistent herewith are hereby repealed.

ORDAINED and ENACTED into an Ordinance this 24 day of March, 1953.

Michael Novak
President

ATTEST:

Miss Lucy Kubler
Secretary

I HEREBY CERTIFY that the foregoing is a true and correct copy of the Ordinance ordained and enacted by the Supervisors of Elder Township on the 24th day of March, 1953.

Lucy Kubler
Secretary of Supervisors of
Elder Township

