

R E P O R T O F V I E W E R S .

To the Honorable, the Judges of the Court of Quarter Sessions of
Cambria County, Pennsylvania.

We, the undersigned members of the board of viewers of Cambria County appointed by your honorable Court, upon the attached order, to view and determine as to the expediency of erecting a new bridge over the North Branch of the Conemaugh Creek near what is known as the Old Toll House, just East of the limits of the Borough of Ebensburg on the Ebensburg-Cresson Pike, in the Township of Cambria, Cambria County, Pennsylvania, respectfully report:-

That having given due notice of the view and of the time and place of meeting of the viewers, to the Commissioners of Cambria County and the Supervisors of the Township of Cambria and having them accept service of notices hereto attached, and to the traveling public by printed hand bills posted in public and conspicuous places at and near the site of the bridge to be viewed; and having been first duly sworn according to law to perform the duties of our appointment faithfully, impartially and to the best of our judgment and ability: all of us met at the time and place appointed in accord with the notices given as aforesaid and having carefully viewed and examined the premises we are all of the opinion that a new, wider and more substantial bridge over the North Branch of the Conemaugh Creek at the place above described is necessary for the accomodation and safety of the traveling public.

The viewers are of the further opinion that the cost of constructing a suitable bridge at the above noted location would be greater than is reasonable the taxpayers of the Township of Cambria should be required to bear and accordingly recommend that the County of Cambria bear the expense of constructing said bridge.

A plot or draft showing the location of said bridge as well as the dimentions thereof together with the width of the permanent

road leading to and from same is hereto attached, ~~and~~ made a part of
this report and herewith returned for public use.

Witness our hands this 24th. day of March, A. D., 1923.

A. M. Shoemaker

J. D. Ritt

Adam Shuman

Viewers.

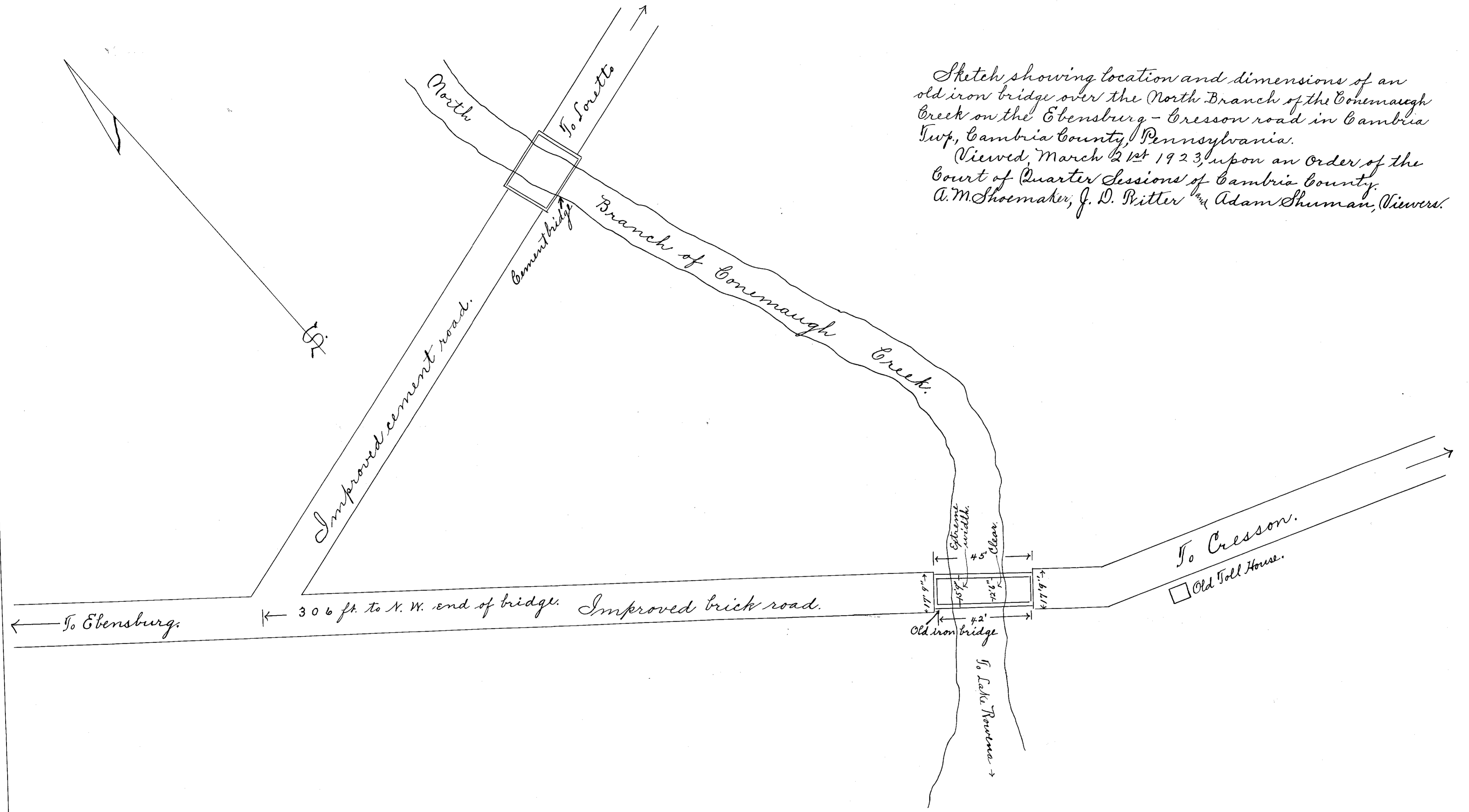

Sketch showing location and dimensions of an old iron bridge over the North Branch of the Conemaugh Creek on the Ebensburg - Cresson road in Cambria Twp., Cambria County, Pennsylvania.
 Viewed March 21st 1923, upon an Order of the Court of Quarter Sessions of Cambria County.
 A. M. Shoemaker, J. D. Ritter and Adam Shuman, Viewers.

3 March lessons 1923

BRIDGE NOTICE!

Notice is hereby given that the Viewers appointed by the Court of Quarter Sessions of Cambria County, Pa., to view and determine as to the expediency of erecting a new bridge over the North Branch of the Conemaugh Creek, near what is known as the "Old Toll House" on the Cresson Pike, just East of the limits of the Borough of Ebensburg, said county and state:

will meet AT THE OLD BRIDGE, AT THE ABOVE NOTED LOCATION, in the Township of Cambria aforesaid, on the 21st. day of March, 1923, at 9:30 o'clock a. m., for the purpose of performing the duties of their appointment.

A. M. Shoemaker,

J. D. Ritter and

Adam Shuman,

Viewers.

Ebg., Pa. March 8th. 1923.

Now, March 8th., 1923, service of the within notice is hereby
accepted for the Commissioners of Cambria County, Pennsylvania.

James M. Colvin, Clerk

Costs of View

A. M. Shoemaker

order _____

4 1/2 Days _____

2 miles _____

Engineering work _____

.90
33.75
.10

15.00
\$49.75

Adam Shuman

1 1/2 Days _____

44 miles _____

11.25
2.20

13.45

J. D. Ritter

1 Days _____

46 miles _____

7.50
2.30

\$9.80

CHAS. F. C. 1923 CERTIFIED

CHAS. F. C. 1923 CERTIFIED

CHAS. F. C. 1923 CERTIFIED

CHAS. F. C. 1923 CERTIFIED

CHAS. F. C. 1923 CERTIFIED

APPROVED FOR PAYMENT
[Signature]
[Signature]

March sess. 1923

IN THE COURT OF QUARTER SESSIONS
OF CAMBRIA COUNTY, PENNSYLVANIA

PETITION

of the Board of Cambria Township
for the location of a new bridge
across the North Branch of the Cons-
hock Creek, near what is known
as the old "Bell House" East of
the limits of the Borough of

Filed 5 March 1923

Walter Jones

WALTER JONES
ATTORNEY AT LAW
EBENSBURG, PA.

IN THE COURT OF QUARTER SESSIONS OF CAMBRIA COUNTY, PENNSYLVANIA

TO THE HONORABLE JUDGES OF THE ABOVE NAMED COURT:

The Petition of the undersigned inhabitants of the Township of Cambria, in the County of Cambria and State of Pennsylvania, respectfully represents:

That the Bridge on the Ebensburg and Cresson Turnpike Road, over the North Branch of the Conemaugh Creek, near what is known as the "Old Toll House", East of the limits of the borough of Ebensburg, is insufficient to accomodate the public travel and is dangerous on account of not being of sufficient width to permit two vehicles to pass.

That the said bridge should be re-constructed and made sufficient width to correspond with the Highway which has just recently been permanently improved.

Your Petitioners, therefore, pray the Court to appoint three persons, qualified according to law, to view the site of said Bridge and report upon the expediency of the erection of a new Bridge to take the place of the existing Bridge.

R. S. Roberts

Daniel Jones

L. F. Rouse

Supervisors of Cambria Township

L. Steiner

L. S. Jones

L. Lloyd

Austin Lloyd

Chatt Brooks

Wm. D. Jones

W. G. Murphy

W. F. Owens

C. Knorr

W. S. Anderson

Wm. Storer

Frank S. Meyer

D E C R E E

And now, March 5th 1923, the within Petition presented in open Court and read and considered, and it is ordered and decreed that Alm Shremaker Esq. J. D. Rutter and Adam Shum be; and they are hereby appointed viewers to view the said Bridge and make report thereon to the Court of Quarter Sessions on the first Monday of next Term.

By the Court
E

IN THE COURT OF QUARTER SESSIONS
OF GAMBRIA COUNTY,
No. 1, MARCH SESSIONS, 1923.

IN RE APPOINTMENT OF INSPECTORS
TO INSPECT BRIDGE OVER NORTH BRANCH
OF CONEMAUGH RIVER NEAR WHAT IS
KNOWN AS THE TOLL HOUSE, EAST OF
BOROUGH LIMITS OF EBENSBURG IN
GAMBRIA TOWNSHIP.

And now, Nov 8, 1923,
the within petition read and
considered, and L. R. Owen

Nicholas Baumgardner and
Philip Campbell appointed
Inspectors on Bridge over North
Branch of Conemaugh River, East
of Borough limits of Ebensburg
in Cambria Township.

By the Court
L.

Filed 8 Nov. 1923

IN THE COURT OF QUARTER SESSIONS OF CAMBRIA COUNTY, NO. 1 MARCH SESSIONS, 1923.
TO THE HONORABLE JUDGES OF THE COURT OF QUARTER SESSIONS OF CAMBRIA COUNTY, PENNSYLVANIA.

The Petition of the Commissioners of Cambria County, respectfully
represents:

That it having appeared to the Court, to the Grand Jury and the Commissioners of said County, that a Bridge over the North Branch of the Conemaugh River, near what is known as the Toll House, East of the limits of the Borough of Ebensburg in Cambria Township, Cambria County, Pennsylvania, was necessary, and that it would be too expensive for the said Township to erect said Bridge; and the same having been entered of record, your Petitioners procured an estimate to be made as nearly as possible, of the expense of the same, and did proceed to have such Bridge erected, by entering in to a contract with R. R. Myers of Lewistown, Pennsylvania, for the building of said bridge for the sum of NINE THOUSAND FOUR HUNDRED TWENTY-NINE and SIXTY-FOUR ONE HUNDREDTHS (\$9429.64) DOLLARS: and that the said Bridge is now completed agreeably to the said Contract at the contract price plus the sum of SEVEN HUNDRED FIFTY-SEVEN and TWENTY ONE HUNDREDTHS (\$757.20) DOLLARS, for extra work found necessary during the progress of the work, making the total cost the sum of TEN THOUSAND ONE HUNDRED EIGHTY-SIX and EIGHTY-FOUR ONE HUNDREDTHS (\$10186.84) DOLLARS. Payments to the amount of SEVEN THOUSAND TWO HUNDRED TWO and THIRTY-EIGHT ONE HUNDREDTHS (\$7202.38) DOLLARS have been paid to the said Contractor, leaving a balance due the said Contractor of TWO THOUSAND NINE HUNDRED EIGHTY-FOUR and FORTY-SIX ONE HUNDREDTHS (\$2984.46) DOLLARS.

Your Petitioners therefore pray the Court to appoint Inspectors to inspect said Bridge and the workmanship thereof, agreeably to the Act of Assembly, and the Supplements and Amendments thereto, and to make report to your Honorable Court.

Attest:

Clerk.

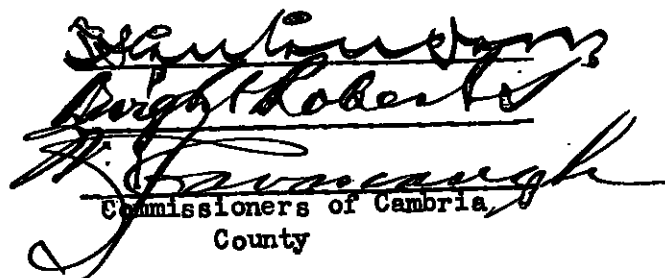
Commissioners of Cambria
County

IN THE COURT OF QUARTER SESS.
OF CAMBRIA COUNTY, PENNA.

NO. 1 MARCH SESSIONS 1923.

IN RE INSPECTION OF BRIDGE
OVER THE NORTH BRANCH OF
CONEMAUGH RIVER NEAR WHAT IS
KNOWN AS THE TOLL HOUSE EAST
OF THE BOROUGH LIMITS OF
EBENSBURG, IN CAMBRIA TOWN-
SHIP, CAMBRIA COUNTY, PENNA.

REPORT OF VIEWERS.

Filed 3 Dec. 1923

MABLON J. BAUMGARDNER
ATTORNEY AT LAW
JOHNSTOWN, PENNA.
SWANK BLDG.

10 December 1923 approved.

By the Court

10 March 1924 Comformed.

Charles G. Roth. Clerk.

In re Bridge over the North
Branch of the Conemaugh River
near what is known as the Toll
House, East of the limits of
the Borough of Ebensburg, in
Cambria Township, Cambria County,
Penna.

In the Court of Quarter Sess-
ions of Cambria County, Penna.
No. 1 March Sessions 1923.

REPORT OF VIEWERS TO INSPECT BRIDGE.

To the Honorable, the Judges of said Court:

We, the undersigned Viewers appointed by the annexed
order of the above Court to view and inspect the above premises
respectfully report:-

That we were duly sworn or affirmed as members of the
permanent Board of Viewers of Cambria County, as shown by the
records of Cambria County, that due public notice of the time
and place of meeting of said Viewers was given by hand bills
posted on the premises, and by notice served upon the Chief
Clerk to the Board of County Commissioners at least ten days
prior to the time of the making of said inspection, evidence of
which is shown by copies of said notices hereto attached; that
we met upon the premises according to the notices given on Monday
November 26th. A. D. 1923 at 10:30 o'clock A. M. and proceeded
with the duties of our appointment. That we made a careful and
thorough investigation and examination of the Plans and Specifi-
cations for the construction of the said Bridge, of the Contract
executed between the Contractor and the County Commissioners of
Cambria County, estimates of same, permit of the water Supply
Commission of the Commonwealth of Pennsylvania to the Commis-
sioners of Cambria County for the construction of the Bridge over
the North Branch of the Conemaugh River near what is known as the
Toll House, east of the limits of the Borough of Ebensburg, in
Cambria Township, Cambria County, Pennsylvania., and all other
data and documents pertaining to the construction of the afore-
said Bridge.

We find that the Bridge is erected in a safe and substantial manner. That all materials used and furnished were in accordance with the Plans and Specifications and that the work is entirely concluded and that the bridge is entirely completed in a satisfactory and acceptable manner.

We therefore recommend that the Bridge be accepted by the County of Cambria, State of Pennsylvania.

WITNESS our hands this First day of December A. D. 1923.

Louis R. Owen
Chas. E. Caulfield
Mathew J. Baumgardner
Viewers.

In re Bridge over the North
Branch of the Conemaugh River
near what is known as the Toll
House, East of the limits of
the Borough of Ebensburg, in
Cambria Township, Cambria County,
Penna.

In the Court of Quarter.
Sessions of Cambria Co.
Penna.
No. 1 March Sessions 1923.

TO MAHLON J. BAUMGARDNER, L. R. OWEN,
and PHILIP CAULFIELD. Drs.

To Mahlon J. Baumgardner, Dr.

Order to View	.90
Data and Preparing Notices to Inspect	7.50
Stenographer and Stationery	3.50
Posting and Serving Notices of Inspection	7.50
Milage	2.00
Inspection	7.50
Mileage	2.00
Examining Plans & Specifications	7.50
Data and Preparing Report	7.50
Stenographer and Stationery	3.50
	<hr/>
	\$ 49 .40

DEC 3 - 1923 CERTIFIED

To L. R. OWEN, Dr.

Making Inspection	7.50
Milage	2.00
Examining Plans & Specifications	7.50
	<hr/>
	\$17.00

DEC 3 - 1923 CERTIFIED

To Philip E. Caulfield, Dr.

Making Inspection	7.50
Milage	2.00
Examining Plans & Specifications	7.50
	<hr/>
	\$17.00

DEC 3 - 1923 CERTIFIED

PAID FOR PAINT
Philip E. Caulfield
H. J. Baumgardner

In re Appointment of Inspectors
to Inspect Bridge over the North
Branch of the Conemaugh River
near what is known as the Toll
House, East of the limits of the
Borough of Ebensburg, in Cambria
Township, Cambria County, Penna.

In the Court of Quarter Sessions
of Cambria County, Penna.

No. 1 March Sessions, 1923.

NOTICE TO INSPECT.

We, the undersigned Viewers, appointed by the above Court
to view and inspect the above mentioned bridge over the North
Branch of the Conemaugh River, near what is known as the Toll
House, East of the limits of the Borough of Ebensburg, in Cambria
Township, Cambria County, Penna. will meet on the bridge November
26th. A. D. 1923 at 10:30 o'clock A. M. for the purpose of performing
the duties of our appointment.

L. R. OWEN,

MAHLON J. BAUMGARDNER,

PHILIP CAULFIELD,

Viewers.

November 12, 1923.

And now November ^{14th} A. D. 1923, I hereby accept service of
the within Notice to Inspect as Chief Clerk for the County Commissioners

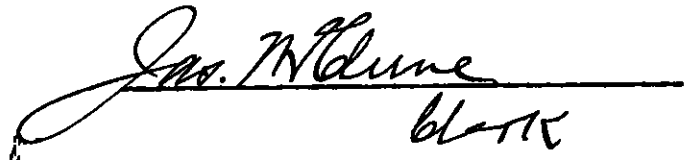
J. W. Dune
Clerk

In re Appointment of Inspectors
to Inspect Bridge over the North
Branch of the Conemaugh River
near what is known as the Toll
House, east of the limits of the
Borough of Ebensburg, in Cambria
Township, Cambria County, Penna.

In the Court of Quarter
Sessions of Cambria County, Pa.

No. 1 March Sessions, 1923.

NOTICE TO INSPECT.

We, the undersigned Viewers, appointed by the above
Court to view and inspect the above mentioned bridge over
the North Branch of the Conemaugh River, near what is known
as the Toll House, East of the limits of the Borough of
Ebensburg, in Cambria Township, Cambria County, Pa. will meet
on the Bridge November 26th., A. D. 1923 at 10:30 o'clock A. M.
for the purpose of performing the duties of our appointment.

L. R. OWEN,

MAHLON J. BAUMGARDNER,

PHILIP GAULEY,

VIEWERS.

November 12, 1923.

No. 1 March Sessions, 1923.

IN THE COURT OF QUARTER
SESSIONS OF CAMBRIA COUNTY,
PENNSYLVANIA.

IN RE APPOINTMENT OF INSPEC-
TORS TO INSPECT BRIDGE OVER
NORTH BRANCH OF CONEMAUGH
RIVER NEAR WHAT IS KNOWN AS
THE TOLL HOUSE, EAST OF
BOROUGH LIMITS OF EBENSBURG,
IN CAMBRIA TOWNSHIP.

ORDER TO VIEW.

And now Nov. 8, 1923
the within petition read and
considered, and L. R. Owen,
Mahlon J. Baumgardner and
Philip Caulfield appointed
Inspectors on Bridge over
North Branch of Conemaugh
River, East of Borough limits
of Ebensburg in Cambria Town-
ship.

BY THE COURT.
E.

IN THE COURT OF QUARTER SESSIONS OF CAMBRIA COUNTY, NO. 1 MARCH
SESSIONS, 1923.

TO THE HONORABLE JUDGES OF THE COURT OF QUARTER SESSIONS OF CAMBRIA
COUNTY, PENNSYLVANIA.

The petition of the Commissioners of Cambria County,
respectfully represents:

That it having appeared to the Court, to the Grand Jury and the
Commissioners of said County, that a Bridge over the North Branch of the
Conemaugh River, near what is known as the Toll House, East of the limits
of the Borough of Ebensburg in Cambria Township, Cambria County, Penn-
sylvania, was necessary, and that it would be too expensive for the
said Township to erect said Bridge; and the same having been entered of
record, your Petitioners procured an estimate to be made as nearly as
possible, of the expense of the same, and did proceed to have such
Bridge erected, by entering into a contract with R. R. Myers of Lewistown
Pennsylvania, for the building of said bridge for the sum of NINE THOU-
SAND FOUR HUNDRED TWENTY-NINE and SIXTY-FOUR ONE HUNDREDTHS (\$9429.64)
DOLLARS; and that the said Bridge is now completed agreeably to the said
Contract at the contract price plus the sum of SEVEN HUNDRED FIFTY-SEVEN
and TWENTY ONE HUNDREDTHS (\$757.20) DOLLARS, for extra work found nece-
ssary during the progress of the work, making the total cost the sum of
TEN THOUSAND ONE HUNDRED EIGHTY-SIX and EIGHTY-FOUR ONE HUNDREDTHS
(\$10186.84) DOLLARS. Payments to the amount of SEVEN THOUSAND TWO HUN-
DRED TWO and THIRTY-EIGHT ONE HUNDREDTHS (\$7202.38) DOLLARS have been paid
to the said Contractor, leaving a balance due the said Contractor of TWO
THOUSAND NINE HUNDRED EIGHTY-FOUR and FORTY-SIX ONE HUNDREDTHS (\$2984.46)
DOLLARS.

Your Petitioners therefore pray the Court to appoint Inspectors
to inspect said Bridge and the workmanship thereof, agreeably to the Act
of Assembly, and the supplements and Amendments thereto, and to make
report to your Honorable Court.

T. Stanton Davis

Dwight Roberts

W. J. Cavanaugh,
Commissioners of Cambria County.

Attest:

Jas. McClune
Clerk.

Extract from the Record.

Certified this 9th day of
November, A. D. 1923.

Frank C. Robt.
Clerk Q. S.

No. 1 March Sessions, 1923.
IN THE COURT OF QUARTER
SESSIONS OF CAMBRIA COUNTY,
PENNSYLVANIA.

In re: Petition of inhabi-
tants of Cambria Township
for the erection of a new
bridge over the north branch
of the Conemaugh Creek, near
what is known as the old "Toll
House" East of the limits of
the Borough of Ebensburg.

ORDER TO VIEW

and

Report of Viewers.

A. M. Shoemaker, |
J. D. Ritter | VIEWERS.
Adam Shuman |

MAR 5 1923 CERTIFIED

Filed 27 March 1923.

Clerk Robb..... 90cts.

IN THE COURT OF QUARTER SESSIONS OF CAMBRIA COUNTY, PENN'A.

In re erection of Bridge over North Branch of Conemaugh Creek,
near what is known as the old "Toll House" East of the limits
of the Borough of Ebensburg, in Cambria Township,

5 March 1923 Petition for appointment of Viewers filed.

The petition of the undersigned inhabitants of the Township
of Cambria, in the County of Cambria and State of Pennsylvania,
respectfully represents:

That the Bridge on the Ebensburg and Cresson Turnpike Road,
over the North Branch of the Conemaugh Creek, near what is known
as the "Old Toll House", East of the limits of the Borough of
Ebensburg, is insufficient to accomodate the public travel and
is dangerous on account of not being of sufficient width to
permit two vehicles to pass.

That the said Bridge should be re-constructed and made sufficient
width to correspond with the Highway which has just recently been
permanently improved.

Your Petitioners, therefore, pray the Court to appoint three
persons, qualified according to law, to view the site of said
bridge and report upon the expediency of the erection of a new
Bridge to take the place of the existing Bridge.

DECREE.

And now, March 5th, 1923, the within Petition presented
in open Court and read and considered, and it is ordered that
A. M. Shoemaker, Esq., J. D. Ritter and Adam Shuman, be, and they
are hereby appointed viewers to view the said Bridge and make report
thereon to the Court of Quarter Sessions on the first Monday of
next Term.

BY THE COURT.
E.

Extract from the Record.
Certified this 6th day of
March, A. D. 1923.

Frank C. Roth
Clerk Q. S.