

Ed # 3 Sept. 1950  
Not Microfilmed

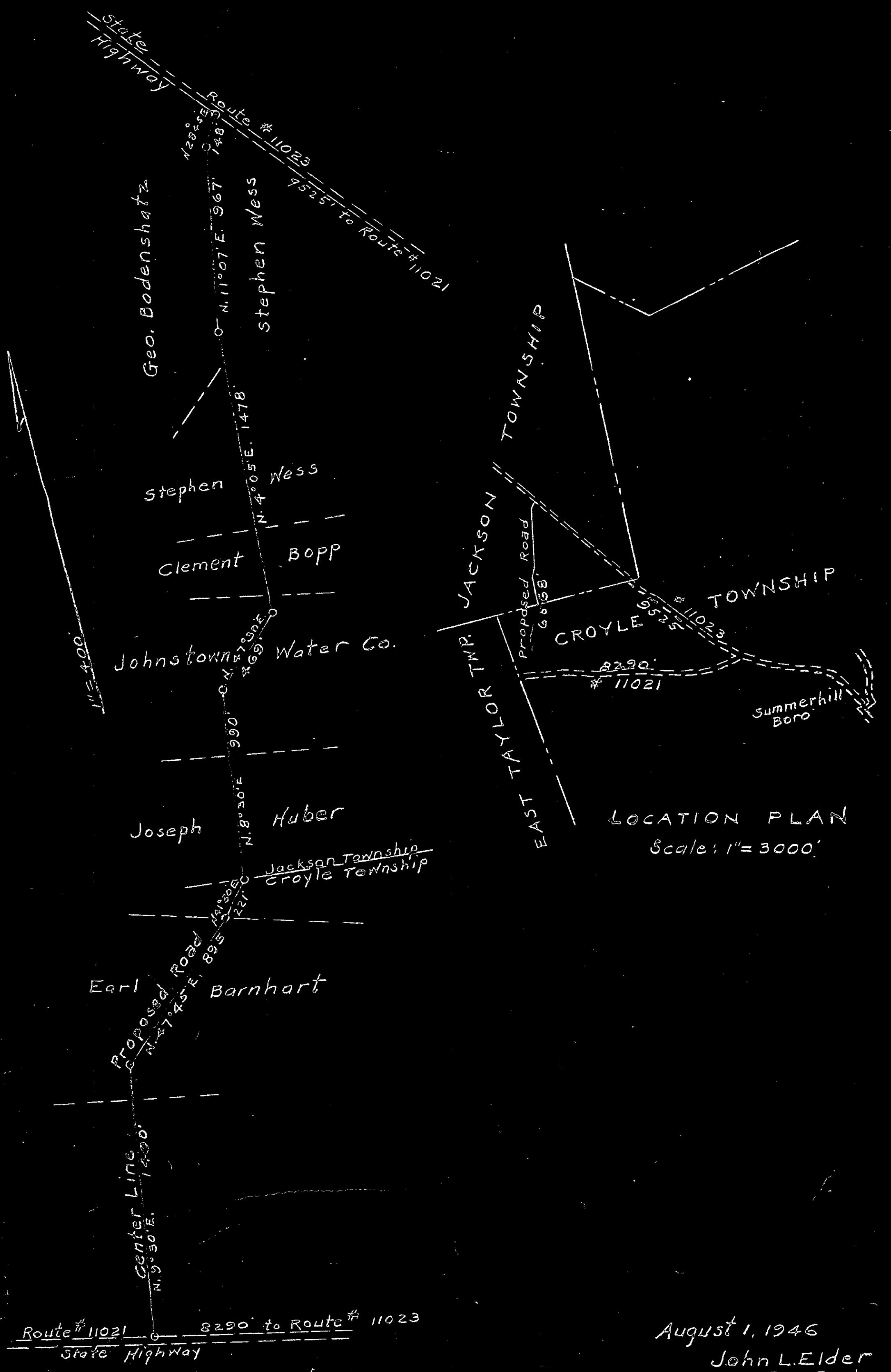

LOCATION PLAN  
Scale: 1" = 3000'

August 1, 1946  
John L. Elder  
Reg. Engr.

IN THE COURT OF QUARTER SESSIONS OF CAMBRIA COUNTY, PENNSYLVANIA

In Re: Laying Out of Public Highway in the Township of Croyle, County of Cambria and State of Pennsylvania, beginning at the Intersection of State Highway Route 11021 to the Boundary Line of Jackson and Croyle Township )

NO. 3 *Sep*. Sessions, 1950

REPORT OF THE SUPERVISORS OF CROYLE TOWNSHIP

The Petition of MICHAEL KISHLOCK, JOSEPH HUBER, and OLIVER W. PLUMMER, respectfully represents:

(1) That they are the Road Supervisors of the Township of Croyle, Cambria County, Pennsylvania.

(2) That they propose to open and lay out a public road in Croyle Township as shown on the blue print hereto attached, made a part hereof, and marked Exhibit "A". Said road shall have a uniform width of 33 feet and a length of 2,516 feet, beginning at the intersection of State Highway Route No. 11021; thence North 9 degrees 30 minutes East, 1400 feet; thence North 47 degrees 45 minutes East 895 feet; thence North 41 degrees 30 minutes East 221 feet to the boundary line of Jackson and Croyle Townships.

(3) That your petitioners have given ten (10) days notice to the property owners effected by the laying out of the said road as required by the Act of Assembly of a hearing and after said hearing your Supervisors deem that said road is necessary for the public convenience. A copy of said notice is hereto attached, made a part hereof and marked Exhibit "B".

(4) Attached hereto and made a part hereof and marked Exhibit "C" is the Resolution of the Board of Supervisors for opening and laying out the above described road.

(5) Attached hereto and made a part hereof and marked Exhibit "D", are the releases executed by the owners of property abutting on said proposed road.

WHEREFORE YOUR petitioners pray that this report and the exhibits attached hereto may be filed in the Office of the Clerk of Courts of Quarter Sessions of Cambria County, Pennsylvania.

Michael Kishlak

Joseph Huber

Oliver M. Plummer  
Road Supervisors of Croyle Township

COUNTY OF CAMBRIA            )  
STATE OF PENNSYLVANIA        ) SS:

Personally appeared before me, a Notary Public in and for said County and State, MICHAEL KISHLOCK, JOSEPH HUBER, and OLIVER W. PLUMMER, Road Supervisors of Croyle Township, Cambria County, Pennsylvania, who being duly sworn according to law, depose and say that the facts set forth in the foregoing report are true and correct to the best of their knowledge, information and belief.

Michael Kishlock  
Joseph Huber  
Oliver W. Plummer

Sworn and subscribed before me  
this 22nd day of August, 1950.

Leone A. Freeman

NOTARY PUBLIC  
My Commission Expires at end of next Session of Senate

IN THE COURT OF QUARTER SESSIONS OF CAMBRIA COUNTY, PENNSYLVANIA

In Re: Laying Out of Public Highway in the Township of Croyle, County of Cambria and State of Pennsylvania, beginning at the Intersection of State Highway Route 11021 to the Boundary Line of Jackson and Croyle Township.

NO. 3 Sept. Sessions, 1950

D E C R E E

NOW, the 28 day of Aug, 1950, upon consideration of the foregoing petition, Joseph C. Wess, Clerk of the Court of Quarter Sessions of Cambria County, Pennsylvania, is hereby directed to file the within report and the exhibits attached thereto.

BY THE COURT,

Wess

Wess

(Name and Address of Property Owner)

Dear Sir:

The Supervisors of Croyle Township propose to open a public road which will abut on your property. A public hearing will be held on the \_\_\_\_\_ day of \_\_\_\_\_, 1950, at \_\_\_\_\_ o'clock \_\_\_\_\_ .M. at \_\_\_\_\_, for the purpose of finally deciding this matter. At this meeting you may examine the plan of said proposed road and offer any testimony in favor of, or in opposition to, said road. The question of damages to property along said road will also be discussed.

BOARD OF SUPERVISORS OF CROYLE TOWNSHIP

By Joseph Huber  
Secretary

RELEASE OF DAMAGES

WHEREAS, we, the undersigned, are owners of property in Croyle Township, Cambria County, Pennsylvania; and

WHEREAS, the Supervisors of Croyle Township propose to open a public road along our property in said Township; and

WHEREAS said public road will be beneficial to us as property owners:

NOW THEREFORE, in consideration of the said public road in Croyle Township, said road having a uniform width of 33 feet and a length of 2,516 feet, beginning at the intersection of State Highway Route No. 11021; thence North 9 degrees 30 minutes East, 1400 feet; thence North 47 degrees 45 minutes East 895 feet; thence North 41 degrees 30 minutes East 221 feet to the boundary line of Jackson and Croyle Townships, we, the undersigned property owners, do hereby release the Township of Croyle, its officials, agents, and employees, of any and all damages we have sustained or may sustain by reason of the accepting, opening, granting, draining, improving and maintaining of said public road.

WITNESS our hands and seals this \_\_\_\_\_ day of \_\_\_\_\_, 1950.

Witness:

<u>Earl E. Barnhart</u>	_____	(Se
<u>Joseph Huber</u>	_____	(Sea
<u>Rose Huber</u>	_____	(Sea
<u>Herman Huber</u>	_____	(Sea
<u>Ray S. Warner</u>	_____	(Sea
_____	_____	(Sea

Witness:

\_\_\_\_\_ (Sea)

\_\_\_\_\_ (Sea)

\_\_\_\_\_ (Sea)

\_\_\_\_\_ (Sea)

\_\_\_\_\_ (Sea)

A RESOLUTION

Providing for the opening, acceptance and adoption of First Street, Second Street, Third Street, Fourth Street, Fifth Street, A Street, and B Street, in the Village of Ehrenfeld, Cambria County, Pennsylvania.

The Township of Croyle hereby ordains as follows:

That First Street, Second Street, Third Street, Fourth Street, Fifth Street, A Street and B Street, as laid out in the Map of the Village of Ehrenfeld, Croyle Township, Cambria County, Pennsylvania, by the Engineering Department of the Pennsylvania Coal and Coke Corporation on October 22, 1947, which plan is recorded in the recorder of deeds in and for Cambria County in Plat Book Vol. 4, Page 40, be opened, accepted and adopted as highways of the Township of Croyle, with the uniform width contained in the aforesaid plan, and in accordance with the lines, courses, distances and grades as therein appear, and the Solicitor of the Township is directed to petition the Court of Quarter Sessions of Cambria County for the Court's approval to the opening, adoption and acceptance of the aforesaid streets.

This Resolution was adopted the \_\_\_\_\_ day of \_\_\_\_\_, 1950.

BOARD OF SUPERVISORS OF  
CROYLE TOWNSHIP

Attest:

Joseph Huber  
Secretary

Michael Kishlock  
President

I, \_\_\_\_\_, Secretary of the Township of Croyle, hereby certify that the above Resolution is a true and correct copy of the same adopted at the \_\_\_\_\_ meeting of the Board of Supervisors of the Township of Croyle, on the \_\_\_\_\_ day of \_\_\_\_\_, 1950, and entered in the minutes and records of the said Township of Croyle.

Joseph Huber

IN THE COURT OF QUARTER SESSIONS OF CAMBRIA COUNTY, PENNSYLVANIA

IN RE: LAYING OUT A PUBLIC  
HIGHWAY IN THE TOWNSHIP OF  
CROYLE, COUNTY OF CAMBRIA AND  
STATE OF PENNSYLVANIA, BEGINNING  
AT THE INTERSECTION OF STATE HIGH-  
WAY ROUTE 11021 TO THE BOUNDARY  
LINE OF JACKSON AND CROYLE TOWNSHIP

No. 3 Sept. Sessions,  
1950

FINAL ORDER

NOW, the 24 day of October, 1950, upon  
consideration of the foregoing petition and it appearing that  
same had been filed in the office of Clerk of Courts of Cambria  
County, Pennsylvania, for a period of thirty (30) days, there  
being no exceptions to said report filed within said period, the  
within report of the Supervisors of Croyle Township is hereby  
approved and the roads as laid out on the attached map may be  
adopted and laid out by the said Supervisors of Croyle Township,  
Cambria County, Pennsylvania, and become Public Roads in said  
Township.

BY THE COURT,



J.

IN THE COURT OF QUARTER SESSIONS  
CAMBRIA COUNTY, PENNA.

NO. *3 Sept* Sessions, 1950

In Re: Laying Out of Public Highway in the Township of Croyle, County of Cambria and State of Pennsylvania, beginning at the Intersection of State Highway Route 11021 to the Boundary Line of Jackson and Croyle Township

REPORT OF THE SUPERVISORS  
OF CROYLE TOWNSHIP

*J.C.F.  
5/25/50*

LAW OFFICES  
SAMUEL R. DI FRANCESCO  
~~XXXXXXXXXX~~

904 ~~704~~ FIRST NATIONAL BANK BLDG.  
JOHNSTOWN, PENNSYLVANIA