

In the Court of Quarter Sessions of Cambria County, Pennsylvania.

To the Honorable Marlin Bingham Stephens, President Judge of said Court:

The Petition of the undersigned, Supervisors of the Townships of Allegheny and Carroll, in said County, respectfully represent:-

That a bridge is much needed over Chest Creek, at the place where the Public Highway leading from Loretto to Carrolltown crosses said Creek, on the line between the Townships aforesaid.

That the erecting of such bridge requires more expense than it is reasonable that said Townships should bear.

Your petitioners therefore pray the Court to appoint proper persons, qualified according to law, to view the place proposed for said bridge, and inquire whether such bridge is necessary, as aforesaid, and make report at the next term of the Court.

John Shetler
M. J. Bradley
John E. Moran
Supervisors of Allegheny Township.

Charles Gaickel
Peter Karabonch
Michael Moller
Supervisors of Carroll Township.

State of Pennsylvania

County of Cambria,

SS:

M. J. Bradley, of the Township of Allegheny, County and State aforesaid, one of the above-named petitioners, being duly sworn according to law, deposes and says that the matters set forth in the above Petition are true and correct, as he verily believes.

Sworn and subscribed before me

this 27th day of March, 1912.

Charles H. Brown
Notary Public
Commission Expires February 21, 1913.

M. J. Bradley

No. 8, June Sessions 1912

In the Court of Quarter-
Sessions of Cambria County,
Pennsylvania.

Petition of the Supervisors
of the Townships of Allegheny
and Carroll for a County
Bridge over Clearfield Creek

Filed 14 June 1912

And now, July 3, 1912
the within petition read
and considered, and
The Court appoint
G. M. Shoemaker,
John S. Sarge and P. H. Campbell
viewers. By the Court

JOHN H. McCANN
ATTORNEY AT LAW
EBENSBURG, PENNSYLVANIA

R E P O R T O F V I E W E R S .

To the Honorable M. B. Stephens, President Judge of the Court of Quarter Sessions of Cambria County, Pa.:-

We, the undersigned members of the Board of Viewers of Cambria County, appointed by your Honorable Court to view the site proposed for the erection of a new County bridge over the Chest Creek, where the road leading from Loretto to Carrolltown crosses said Creek on the line between the Townships of Allegheny and Carroll as set forth in the order of Court hereto attached, respectfully report:-

That having given due notice of the View and of the time and place of meeting of the Viewers, by serving notice on the County Commissioners and the Supervisors of the Townships, above mentioned and to the public by printed hand bills posted in public and conspicuous places at and near the site of the proposed new bridge; all of us met at the said site in accordance with the notices so given and having been first duly qualified according to law to perform the duties of our appointment faithfully, impartially and to the best of our ability: We viewed the premises aforesaid and are of opinion that there is occasion for a new bridge over the Chest Creek on the line between the Townships aforesaid, but owing to the location suggested as a site for the new bridge, we refused to recommend that a new bridge be built by the County at this point.

The present old bridge standing on the site suggested for the new bridge is located on an abrupt turn in the public road, which said bridge and abrupt turn in the road is just about midway between two other abrupt and awkward turns or elbows in the Township road; all of which awkward and dangerous curves might be eliminated by a change in the location of the present road bed for some three to six hundred feet beyond the approaches on either side of the

present old bridge, as this however would change the site of the bridge over the said creek so much that, under the order of Court hereto attached and to us directed, we are convinced- In contrary to the opinion of the Counsel for the Petitioners- that we have no authority to suggest a new location for the bridge nor that a new bridge be constructed on private property at a new and entirely new location to which at the present time, there is no Township road leading. Therefore we report that a new bridge ought not to be constructed by the County at this point, noted in the attached order. A plot showing the location of proposed bridge is hereto attached and made a part of this report.

Witness our hands this eighth day of August, A. D., 1912.

A. M. Shoemaker

D. J. Campbell

J. L. Singer
Viewers.

Cost of View.

P. F. Campbell.

2 Days \$10.00

Livery hire 2.50

meals 1.00

Chainman pd by P.F.C. 1.50

A. M. Shoemaker.

Lifting Order .90

2 1/2 Days 12.50

Livery hire 2.50

Horse feed & meal .75

John L. Singer

1 Day 5.00

Horse hire, feed
& meals - 6.75

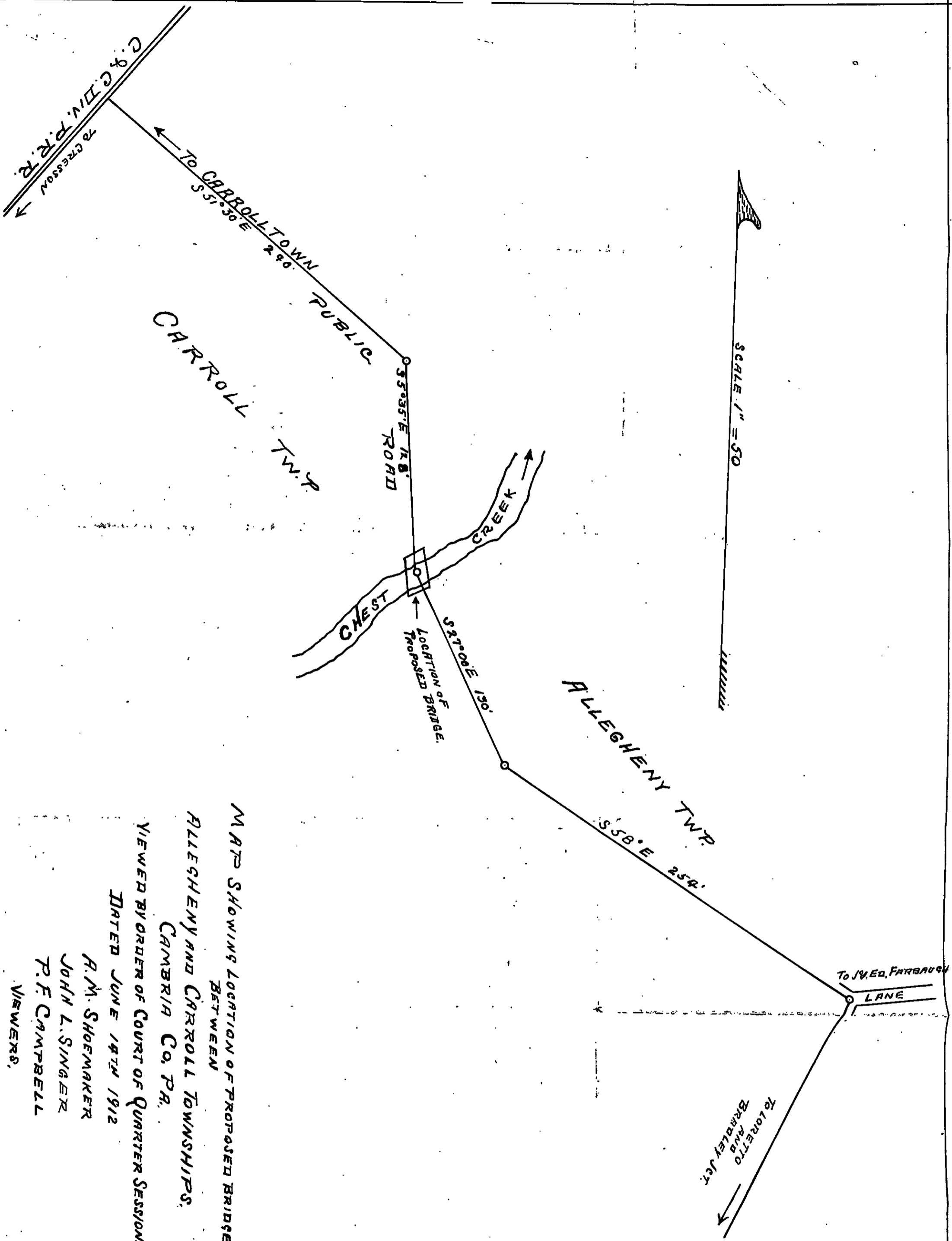

MAP SHOWING LOCATION OF PROPOSED BRIDGE
 BETWEEN
 ALLEGHENY AND CARROLL TOWNSHIPS,
 CAMBRIA Co. PA.

VIEWED BY ORDER OF COURT OF QUARTER SESSIONS.

DATED JUNE 14TH 1912

A.M. SHOEMAKER
 JOHN L. SINGER
 P.F. CAMPBELL
 VIEWERS.

BRIDGE NOTICE!

Notice is hereby given that the Viewers appointed by the Court of Quarter Sessions to view the site and determine as to the necessity of erecting a bridge over the Chest Creek, at the place where the public highway leading from Loretta to Carrolltown crosses the said creek, on the line between the townships of Carroll and Allegheny, in Cambria Co., Pa.

will meet at the site proposed for said bridge between the Townships of Carroll & Allegheny aforesaid, on the 3rd day of August 1912, at 10:30 o'clock a.m., for the purpose of viewing said ground.

A. M. Shoemaker
P. F. Campbell
John S. Dinger
Viewers.

July 23rd 1912

Service of the within notice accepted
for the County Commissioners
July 9th 1912

W. C. Brown
clerk

BRIDGE NOTICE!

Notice is hereby given that the Viewers appointed by the Court of Quarter Sessions to view the *site and determine as to the necessity of erecting a bridge over the Chest Creek, at the place where the public highway leading from Loretto to Carrolltown crosses the said creek on the line between the townships of Carroll & Allegheny, in Cambria Co., Pa.*

will meet at the *site proposed for said bridge between* the Township S of *Carroll & Allegheny* foreshaid, on the *5th* day of *August* 191*2*, at *10:30* o'clock *a.m.*, for the purpose of viewing said ground.

A. W. Shoemaker
P. F. Campbell
John L. Singer
Viewers.

July 23rd 191*2*

now 1912, service of the within
notice accepted by the under-
signed supervisors of the
township of Allegheny —

W. J. Bradley

John Sheehan

John C. Moran

Supervisors

BRIDGE NOTICE!

Notice is hereby given that the Viewers appointed by the Court of Quarter Sessions to view the site and determine as to the

necessity of erecting a bridge over the Chest Creek at the place where the public highway leading from Foxetta to Carrolltown crosses the said creek, on the line between the townships of Carroll & Allegheny in Cambria Co., Pa.

will meet at the site proposed for said bridge between the Townships of Allegheny & Carroll aforesaid, on the 5th day of August 1912, at 10:30 o'clock a.m., for the purpose of viewing said ground.

A. M. Shoemaker
P. F. Campbell
John L. Singer
Viewers.

July 23rd

1912

Now July 1912, service of the
within notice accepted by the
undersigned supervisors of the
Township of Carroll

Charles Guekley

Michael Mahler

Peter Liorabough

Supervisors

BRIDGE NOTICE!

Notice is hereby given that the Viewers appointed by the Court of Quarter Sessions to view the *site & location of a bridge* *to*

cross the creek on
the site of the bridge
between the
Carroll, in Columbia Co., Pa.

will meet at the *place* *between* the Townships
of *Allegheny* aforesaid, on the *5th* day of *August*
191*2*, at *10:30* o'clock *a.m.*, for the purpose of viewing said ground.

July 23rd 191*2*

(1. B. ...)
F. ...
Viewers.

NO. 8 June SESSION, 1912

Order to view Bridge over Chest
Creek where road leading from
Loretto to Carrolltown crosses
on line between the two Twp.

*Filed 2 Sept. 1912 in Open
Court*

Certified SEP 15 1912 C.S.A.

Viewers
A. M. Shoemaker
John L. Singer
P. F. Campbell

Certified SEP 16 1912 C.S.A.

Clerk McCANN 90 cts.

REISSING MOUNTAINEER-HERALD ELECTRIC PRINT.

NOTE. "It shall be the duty of all persons appointed in the several counties of this Commonwealth to view and review any public or private road or bridge, if they shall decide in favor of locating said road or bridge, to endeavor to procure from the person or persons over whose land such location may be made releases from all claims for damages that might arise from the opening of such road or the building of such bridge; and in every case where said viewers shall fail to procure such releases, and it shall appear to them that any damages will be sustained, it shall be their duty to assess the damages and make report thereof signed by a majority of their number, and return the same, together with all releases obtained, to the Court of Quarter Sessions, and the damages so assessed shall be conclusive, or may be subject to appeal, review or modification, as may be provided by existing laws in the different counties of this Commonwealth."

"The persons appointed as aforesaid shall view such ground, and if they shall agree that there is occasion for a road, they shall proceed to lay out the same, having respect to the shortest distance, and the best ground for a road, and in such manner as shall do the least injury to private property, and also be, as far as practicable, agreeable to the desire of the petitioners."

"The viewers, as aforesaid, shall make report at the next term of said Court, and in the said report shall state particularly: First, who of them were present at the view, second, whether they were severally sworn or affirmed; third, whether the road desired be necessary for a public or private road; they shall also annex and return to the Court a plot or draft thereof, stating the courses and distances, and noting briefly the improvements through which it may pass; and, whenever practicable, the viewers shall lay out the said roads at an elevation not exceeding five degrees (except at the crossing of ravines and streams), where, by moderate filling and bridging, the declination of the road may be preserved within that limit."