

R.D. #6 H6 AC 1911
Nat. Microfilm

John Huebner
John Hannan
C.P. Collins } Viewers.

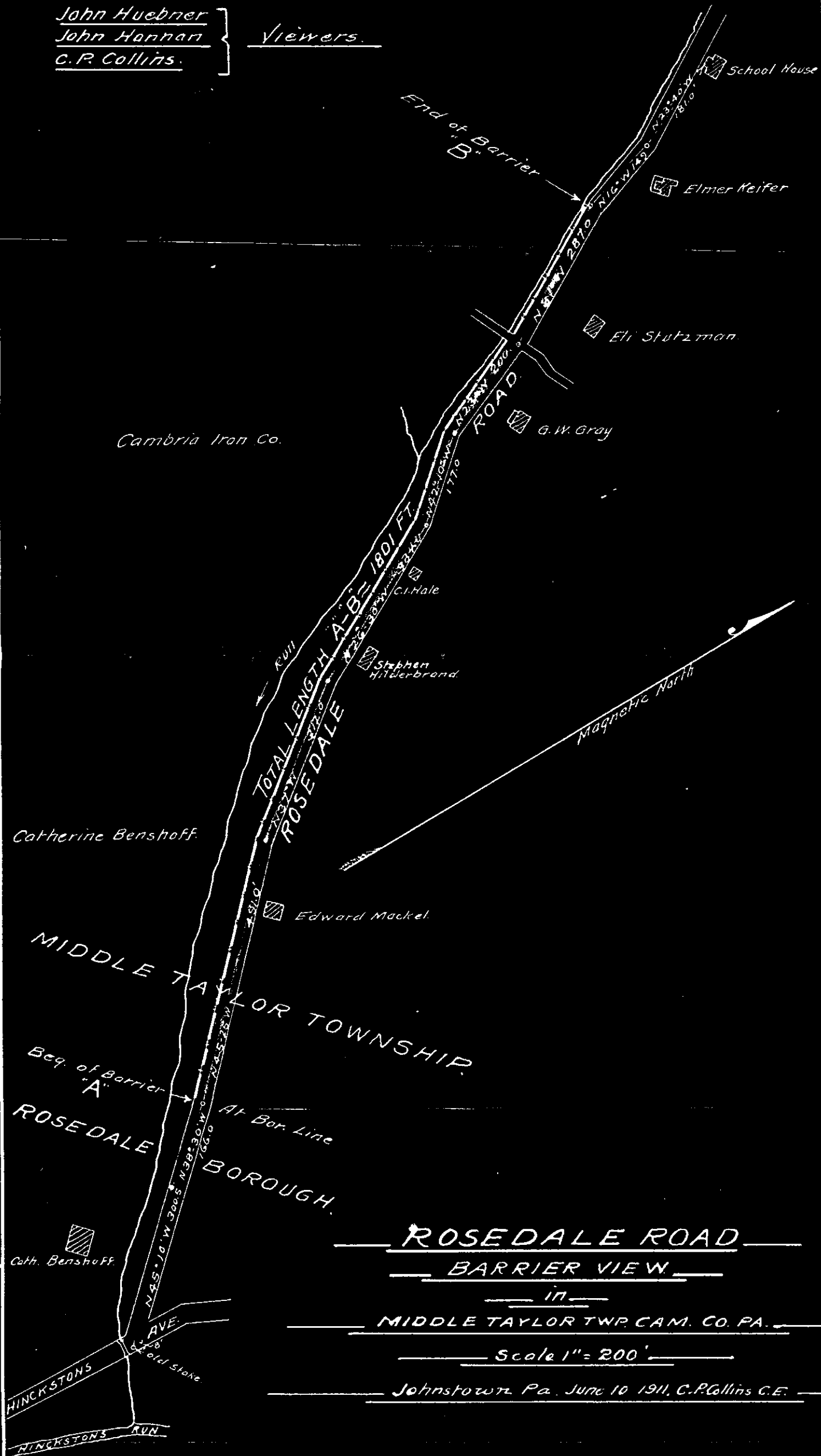

TOTAL LENGTH A-B 1801 FT.
ROSEDALE

MIDDLE TAYLOR TOWNSHIP

ROSEDALE BOROUGH

ROSEDALE ROAD
BARRIER VIEW

MIDDLE TAYLOR TWP. CAM. CO. PA.

Scale 1" = 200'

Johnstown Pa. June 10 1911, C.P. Collins C.E.

Cath. Benshoff

Edward Mackel

Stephen Hilberbrand

C.I. Hale

G.W. Gray

Eli Stutzman

Elmer Keifer

School House

Cambria Iron Co.

Catherine Benshoff

Beq. of Barrier "A"

At Bar. Line

End of Barrier "B"

Magnetic North

Old Stone

HINCKSTONS RUN

HINCKSTONS RUN

In the Court of Quarter Sessions of Cambria County, Penna.

To the Honorable F. J. O'Connor, President Judge of said Court:

The petition of the undersigned inhabitants of Middle Taylor Township, Cambria County, respectfully represent; That there is need for a barrier upon a public highway between points hereinafter mentioned, and that the expense of erecting the same is more than the Township can reasonably bear; the said portions of the aforesaid highway needing barriers being entirely within the said Township of Middle Taylor and described thus: For a portion of a public highway known as *Rosedale Road* leading from Rosedale at its intersection with *Hinckston Ave.* Street, formerly the Hinckston Run Road; and thence following said highway to its intersection with the Ben-shoff Hill Road, also a public highway, at the Pleasant View Church; a distance of four-tenths of a mile.

Wherefore your petitioners pray the Court to order a view in the manner provided for in the case of roads to view the premises for the purpose of determining whether or not such guards or barriers are necessary and whether or not the same would be too expensive for said Township to erect and maintain; and report to make thereon as provided by the Act of Assembly of May 25, 1878, P. L. 150 and its supplements.

Elmer Kiefer

J. M. Lippitt

Joseph White

H. C. Sillinger

Thos. P. Barbair

John E. Heine

Les Beardsley

Emanuel Rhodes

Waldo E. Rhodes
B. F. Groat

D. J. Rhodes

Frank Brehme

Harry Bassett

H. H. Bellamy

John T. Beebe

Ernest Brehme

John S. Stutzman
Jas. ...

Emma Keys
E. D. Blue

H. C. Findley

F. L. Findley

Francis Croyle

L. H. Lusk

Stephen Hildebrand
M. S. Metzger

Man. Boudierick

H. S. Traylor

W. T. Hanson
John Hildebrand

Chas. i. Hale

G. W. Gray

Ed. Stutzman

Morris Carter

G. G. Lind

Edward Mackell

Gambria County, ss;

Personally appeared before me, the undersigned authority,
Elmer Keifer, who, having been duly affirmed accord-
ing to law, deposes and says that the statements made in the fore-
going petition are true and correct.

Elmer Keifer

Affirmed and subscribed to before me this 11th day of
March, A. D. 1911.

Florence M. Grier,
Notary Public.

My commission expires
end of session of Senate.

I hereby accept service of notice of within petition
to be presented at March Term of Court of Quarter (1911)
Sessions of Cambria Co.

W. B. Lewis

W. B. Lewis
Twp

Board of Supervisors of Middle
Taylor Twp.

We, the undersigned Commissioners of Cambria County,
hereby accept service of notice of within petition to be
presented at March Term of Court Quarter (1911) Sessions
of Cambria Co.

W. B. Lewis

W. B. Lewis
County Commissioners.

No. 6 March Term 1911

Law Court of Quarter Sessions
of Columbia County 1911
Petition of ^{March Term}

Middle Taylor Twp.
inhabitants for
barriers along highway
known as Rosedale Road
to Pleasant View Church.

Filed 20 March 1911,

Nov 20 1911
written petition read
approved
John H. Lawrence John
Huebner C. D. Collins
appointed referees at
written prayers
By the Court

CHARLES C. GREER
LAWYER
JOHNSTOWN, PA.

TO THE HONORABLE MARLIN B. STEPHENS,
PRESIDENT JUDGE OF THE COURT OF COMMON PLEAS
OF CAMBERIA COUNTY.

We, the undersigned, having been appointed by the Court to inspect the guard rails recently erected on the public road leading from the Rosedale Borough line to a point near the Pleasant View Church in Middle Taylor Township, after having been severly sworn, stste that we have attended to the duties of the appointment, and beg to report as follows:

That having examined the said Guard Rails, we find them to be erected according to the contract, plans and specifications and in a workmanlike manner, and we hereby approve the same and recommend that the contractor, D. F. Benschhoff be paid fot the erection and construction of he same, the sum of 27 cents per lineal foot as per contract.

Witness our hands and seals this 7th day of December 1912

James Davis (SEAL)
Baron Stutman (SEAL)
Emanuel Rhodes (SEAL)
A. M. Griggs (SEAL)
Elmer Kuper (SEAL)
_____ (SEAL)

No. 6 March 1911

Filed 9 Dec 1912

[Handwritten signatures and scribbles]

PETITION

Of the County Commissioners for the appointment of inspectors to inspect the bridge across

Guard Rails ~~at~~ in Middle Taylor Township.

And now Dec. 7 A. D. 1912 the within petition read and considered and the following persons appointed Inspectors:

- James Davis*
- Aaron Stutzman*
- Elmer Keifer*
- Charles Tomb*
- Emanuel Rhodes*
- John M. Griffith*

To make report to the next Court of Quarter Sessions:

[Signature]

Attorney.

Filed *7 December* 1912

To the Honorable F. J. O'Connor, President Judge of the Court of Quarter Sessions of Cambria County, Pa.

We, the undersigned, appointed by the annexed order do report: That, in pursuance thereof, after having been severally sworn or affirmed, all the Viewers appointed by said order viewed the ground for the within mentioned barriers and do agree that there is occasion for barriers, as desired by the petitioners, and that the same are necessary for public safety. And do further report that the expenses incident to the erection and completion of the same are greater than the Township could reasonably bear, and therefore recommend that the said barriers be erected at the expense of the County.

We do further report that notice of the view was given to the *County Commissioners and* Board of Supervisors and by advertisement in conspicuous places in the vicinity ten days before said meeting, and we further annex a plot or draft of the road indicating the location of said barriers.

Witness our hands this *13th* day of June, 1911.

John Wannon
John Hucker
C. C. Collins

Viewers.

Bill of Costs.

C. P. Collins - Services as Viewer,	5.00	
Mileage,	.30	
Survey,	5.00	
Lunch & Mileage,	.60	
Services in office,	5.00	
Blue-printing & Materials,	<u>.25</u>	\$16.15
John Hannan - Services as Viewer,	3.00	
Mileage,	<u>.30</u>	3.30
John Huebner - Services as Viewer,	3.00	
Mileage,	<u>.30</u>	3.30
Florence M. Govier - Affidavits,		<u>.75</u>
		\$23.50

Notice of View No. 6, March Session, 1911 to determine if barriers are necessary in Middle Taylor Township.

Notice is hereby given that the Viewers appointed by the Court of Quarter Sessions to view the ground and determine whether or not barriers are necessary upon a public highway in the Township of Middle Taylor, the said portion of the aforesaid highway needing barriers being entirely within the said Township of Middle Taylor and described thus:

For a portion of a public highway known as Rosedale Road leading from Rosedale at its intersection with Hinckston Ave. formerly the Hinckston Run Road; and thence following said highway to its intersection with the Benshoff Hill Road also a public highway, at the Pleasant View Church; a distance of four-tenths of a mile, will meet at the intersection of Rosedale Road and Hinckston Avenue on the 26th day of May, 1911, at 11 A. M. , for the purpose of viewing said ground.

John Hannan,

John Huebner,

C. F. Collins,

Viewers.

We, the undersigned Supervisors of Middle Taylor Township, hereby accept service of notice of the within view, and of presentation of petition therefor.

Emmanuel Rhodes
Johnny Griffith
Edward Higgins
Supervisors of Middle Taylor Township.

Notice therefor.

Receipt service of notice of the within view, and of presentation of

as, the undersigned representatives of Middle Taylor Township, hereby

Witness.

J. E. Collins,

John Wagner,

John Manning,

By V. H. , for the purpose of viewing said ground.

Roadside Road and Hinckston Avenue, on the 28th day of May, 1911, at

a distance of four-fifths of a mile, will meet at the intersection of

Denhoff Hill Road and a proposed highway, at the Pleasant View Church;

from road; and thence following said highway to the intersection with the

Roadside at its intersection with Hinckston Ave. formerly the Hinckston

For a portion of a public highway known as Roadside Road leading from

entirely within the said Township of Middle Taylor and described thus:

to-wit: the said portion of the aforesaid highway needing barrier-planting

barriers are necessary upon a public highway in the Township of Middle

of Quarter Sessions to view the ground and determine whether or not

Notice is hereby given that the views are cited by the Court

necessary in Middle Taylor Township.

Notice of View No. 6, Ward 1, Session, 1911 to determine if barriers are

Notice of View No. 6, March Session, 1911 to determine if barriers are necessary in Middle Taylor Township.

Notice is hereby given that the Viewers appointed by the Court of Quarter Sessions to view the ground and determine whether or not barriers are necessary upon a public highway in the Township of Middle Taylor, the said portion of the aforesaid highway needing barriers being entirely within the said Township of Middle Taylor and described thus: For a portion of a public highway known as Rosedale Road leading from Rosedale at its intersection with Hinckston Ave. formerly the Hinckston Run Road; and thence following said highway to its intersection with the Benshoff Hill Road also a public highway, at the Pleasant View Church; a distance of four-tenths of a mile, will meet at the intersection of Rosedale Road and Hinckston Avenue on the 26th day of May, 1911, at 11 A. M. for the purpose of viewing said ground.

John Hannan,

John Huebner,

G. P. Collins,

Viewers.

We, the undersigned Commissioners of Cambria County, hereby accept service of notice of the within view and of presentation of petition therefor.

L. E. Toyell Clerk

For

Commissioners of Cambria County.

therefor.

receipt of notice of the within view and of presentation of petition.

As the undersigned Commissioners of said County, hereby accept

Viewers.

O. L. Collins,

John Humber,

John Hansen,

1911, at 11 A. M. for the purpose of viewing said ground.

Section of Rosedale Road and Hinkkaton Avenue on the 30th day of May,

view thereof; a distance of four tenths of a mile, will meet at the inter-

section with the Benham Hill Road also a public highway, at the Pleasant

Hinkkaton Run Road, and thence following said highway to its intersect-

tion with Rosedale at its intersection with Hinkkaton Ave. formerly the

line: For a portion of the said highway known as Rosedale Road leading

and entirely within the said Township of Middle Taylor and described

Taylor, the said portion of the aforesaid highway needing barriers be-

barriers are necessary upon a public highway in the Township of Middle

of Quarter Sessions to view the ground and determine whether or not

Notice is hereby given that the Viewers appointed by the Court

necessary in Middle Taylor Township.

Notice of View No. 6, March Session, 1911 to determine if barriers are

No. 6.

Accepted
John Humber
John Hansen

John Humber
John Hansen

Notice of View No. 6, March Sessions, 1911 to determine if barriers are necessary in Middle Taylor Township.

Notice is hereby given that the Viewers appointed by the Court of Quarter Sessions to view the ground and determine whether or not barriers are necessary upon a public highway in the Township of Middle Taylor, the said portion of the aforesaid highway needing barriers being entirely within the said Township of Middle Taylor and described thus: For a portion of a public highway known as Rosedale Road leading from Rosedale at its intersection with Hinckston Ave. formerly the Hinckston Run Road; and thence following said highway to its intersection with the Benshoff Hill Road also a public highway, at the Pleasant View Church; a distance of four-tenths of a mile, will meet at the intersection of Rosedale Road and Hinckston Avenue on the 26 day of May, 1911 at 10 A. M., for the purpose of viewing said ground.

John Hannan,
John Huebner,
C. P. Collins,
Viewers.

State of Pennsylvania, : ss.
Cambria County, :

Personally appeared before me, the undersigned authority,
John Huebner, John Hannan and C. P. Collins, who having been severally
duly affirmed according to law, say they will perform their duties as
Viewers in the within named proceedings with zeal and fidelity.

Affirmed and subscribed to . :
before me, this 26th day of May, :
A. D. 1911. :

John Huebner
John Hannan

Florence M. Giviel
Notary Public.

C. P. Collins

My com. expires Feby. 21, 1915.

No. 6, March Session, 1911.

Order to view and determine
if barriers are necessary
in Middle Taylor Township.

John Huebner,
John Hannan,
C. P. Collins,
viewers.

Clerk Kinkead 90cts.
Greer.

<p>In the Court of Quarter Sessions of Cambria Co., Pa. No. 6, March Session, 1911.</p>	<p>Report of Viewers to determine if barriers are necessary etc. in middle Taylor Twp. along Rose Lake Road.</p>		<p>Filed 15 June, 1911, in open Court.</p> <p>CHARLES C. GREER LAWYER JOHNSTOWN, PA.</p>
---	--	--	--

Not Dec 7, 1911 Granting affirm
 removal of barriers as then mentioned
 at Court's expense.

above recommendation is on a former
 record in and approved by the court
 Dec. 7, 1911 } P. A. Struthmatter