

R. D. #7 June 1907
Not microfilmed

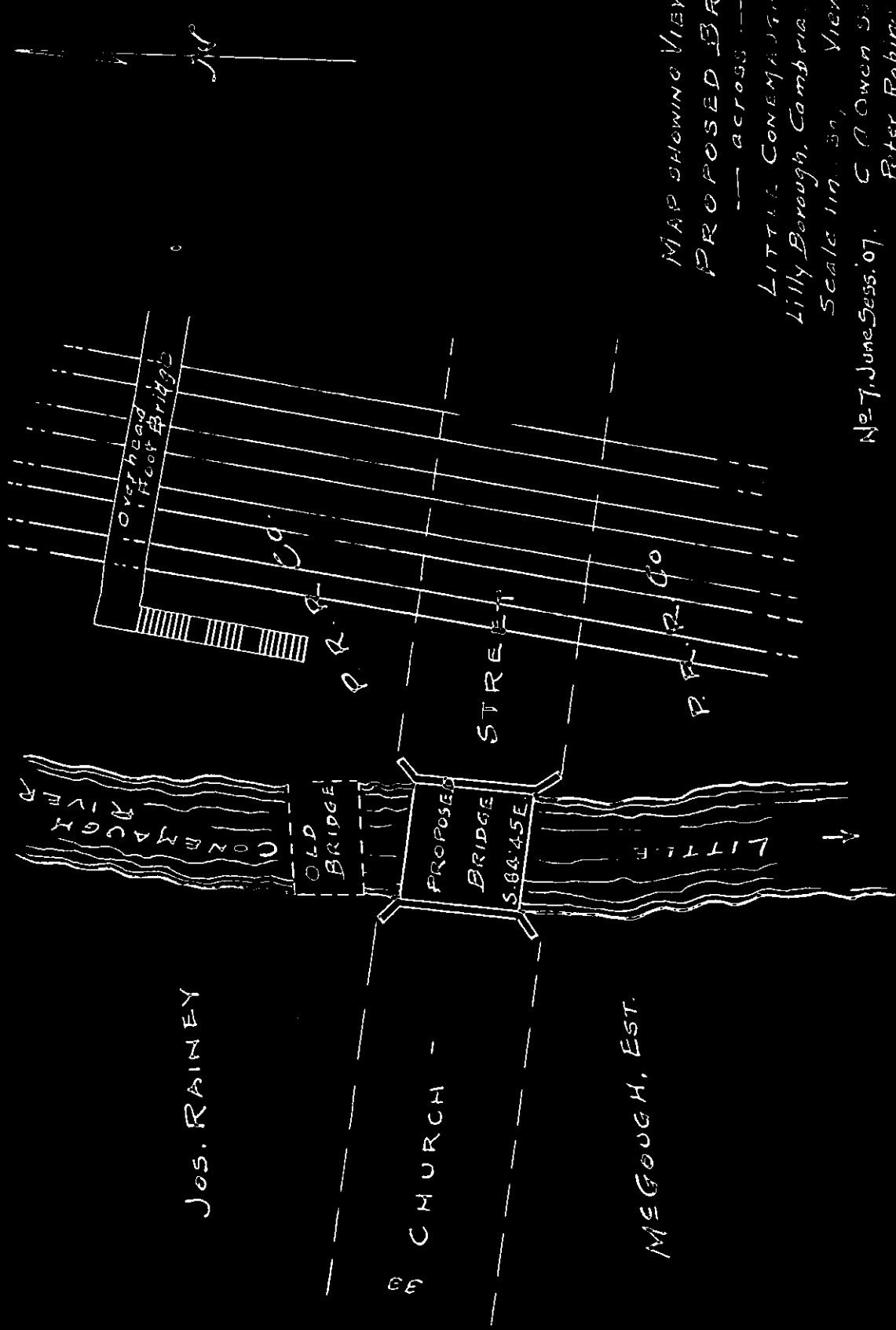

MAP SHOWING VIEW OF
PROPOSED BRIDGE
--- across ---

LITTLE CONEMACH RIVER
Lillyborough, Cambria.

Scale 1 in. = 50 ft. Viewed, Aug 29, 07
C. Owen Surveyor } Viewers
Peter Robins }
Dan. A. McGeough }

Length of Bridge between abutments, 24 ft.
Width, 24 ft. Driveway, 10 ft. One Walk, North Side 6 ft. wide.
Height of Floor about 6 in. below P. R. R. Track.

JOS. RAINEY

CHURCH -

MEGOUCH, EST.

IN THE COURT OF QUARTER SESSIONS OF CAMBRIA COUNTY, PA.

No. 7, June Sessions, 1907.

To the Honorable Francis J. O'Connor, President Judge of said Court,

The undersigned viewers appointed by the annexed order to view, issued out of the said Court, do respectfully report: :

That having given due public notice as required by law, and having notified the County Commissioners and the Town Council of the Borough of Lilly, they met at the time and place appointed by said notice ; to-wit, on the site for the proposed permanent bridge on Church Street in the said Borough of Lilly where said street crosses the stream between the property of Joseph Rainey and the Pennsylvania Railroad crossing, on Thursday the 29th day of August, A. D. 1907, at two o'clock in the afternoon, and having been sworn to perform their duties under the appointment contained in said order impartially and to the best of their judgment, proceeded to the performance of the duties imposed upon them by said order to view, and having examined the said site, the condition of the present bridge and the need of a good permanent bridge at the place mentioned, do report that there is occasion for the building of a new permanent bridge at the place mentioned and that the erecting of said bridge would require more expense than it is reasonable that the Borough of Lilly should bear; they therefore report in favor of the erection of the proposed bridge and that same be paid for in whole or part by the County Commissioners. All the land required for said bridge is a part of a public street of said borough. A draft of the proposed bridge is hereto annexed and made a part of this report.

P. A. Owen

Peter Robinson

Daniel A. McCough

Viewers.

No. 7, June Sessions, 1907.

STATE OF PENNSYLVANIA,
COUNTY OF CAMBRIA, SS.

Before me the subscriber, a Justice of Peace, in and for said County, on the 29th day of August, A. D. 1907, personally came C. A. Owen, Peter Robine, Jr., and Daniel A. McGough, the viewers appointed by the Court of Quarter Sessions of Cambria County to No. 7, June Sessions, 1907, and being severally sworn according to law depose and say that they will perform the duties under the appointment contained in said order impartially and according to the best of their judgment.

C. A. Owen

Peter Robine Jr

Daniel A. McGough

Sworn and subscribed to before me on the date aforesaid.

C. A. McYoungle

Justice of the Peace.

My Commission Expires May 3rd 1909

NOTICE OF BRIDGE VIEW.

No. 7, June Sessions, 1907, R. D.

NOTICE is hereby given that the undersigned viewers appointed by the Court of Quarter Sessions of Cambria County, to view the site and report to said Court for a proposed bridge on Church Street in the Borough of Lilly, where said street crosses the stream between the property of Joseph Rainey and the Pennsylvania Railroad Crossing, will meet at the location for said proposed bridge in the Borough of Lilly, on Thursday the 29th day of August, A. D. 1907, at one o'clock in the afternoon, when and where all persons interested may attend if they see proper.

C. A. OWEN, Surveyor,
PETER ROBINE, Jr.,
DANIEL A. McGOUGH. | Viewers.

Lilly, Pa., August 16, 1907.

Office of County Commissioners, Ebensburg, Pa., August 19, 1907.

I hereby accept service of the above notice of bridge view, for the County Commissioners.

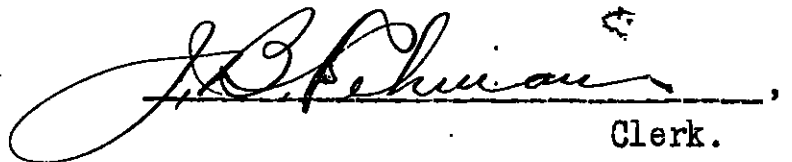
Clerk.

Commonwealth of Pennsylvania, }
County of Cambria. }

At a Court of Quarter Sessions of the Peace of the County of Cambria held at Ebensburg, in the said County, on the thirde day of June A. D. 1907, before the Honorable Judge of the said Court: Upon the petition of divers inhabitants of the Borough of Lilly, in the said County, setting forth that they labor under inconvenience for want of a road or highway, to lead from

there is great need for the erection of a permanent bridge, on Church Street in the said Borough, across the stream between the property of Joseph Ransier and the Pennsylvania Railroad crossing and that the erection of a suitable bridge of a permanent character at the place mentioned, would require more expense than it is reasonable that the Borough of Lilly should bear; they therefore respectfully pray your Honorable Court to appoint viewers to view the sight of proposed bridge and report to the next Term of Court.

~~and therefore praying the Court to appoint proper persons to view and lay out the same according to law.~~ The Court, upon due consideration had of the premises, do order and appoint

Is. A. Owen surveyor, and

Peter Robins Jr, and Daniel Mc Gough

viewers, to view the ground proposed for said ~~road~~ ^{bridge} and if they view the same, and shall agree that there is occasion for such ~~road~~ ^{bridge}, they shall proceed to lay out the same, having respect to the shortest distance and the best ground for a road, and in such manner as shall do the least injury to private property, and also be as far as practicable, agreeable to the desires of the petitioners, and that they make a report of their proceedings to the next Court of Quarter Sessions to be held for said County, ~~stating particularly whether they judge the same necessary for a public or private road, together with a plot or draft thereof, and the courses and distances, and references to the improvements through which it may pass.~~

By the Court.

Attest:

Lo E. Troffell, Clerk.

NOTE. "It shall be the duty of all persons appointed in the several counties of this Commonwealth to view and review any public or private road or bridge, if they shall decide in favor of locating said road or bridge, to endeavor to procure from the person or persons over whose land such location may be made releases from all claims for damages that might arise from the opening of such road or the building of such bridge; and in every case where said viewers shall fail to procure such releases, and it shall appear to them that any damages will be sustained, it shall be their duty to assess the damages and make report thereof signed by a majority of their number, and return the same, together with all releases obtained, to the Court of Quarter Sessions, and the damages so assessed shall be conclusive, or may be subject to appeal, review or modification, as may be provided by existing laws in the different counties of this Commonwealth."

"The persons appointed as aforesaid shall view such ground, and if they shall agree that there is occasion for a road, they shall proceed to lay out the same, having respect to the shortest distance, and the best ground for a road, and in such manner as shall do the least injury to private property, and also be, as far as practicable, agreeable to the desire of the petitioners."

"The viewers, as aforesaid, shall make report at the next term of said Court, and in the said report shall state particularly: First, who of them were present at the view, second, whether they were severally sworn or affirmed; third, whether the road desired be necessary for a public or private road; they shall also annex and return to the Court a plot or draft thereof, stating the courses and distances, and noting briefly the improvements through which it may pass; and, whenever practicable, the viewers shall lay out the said roads at an elevation not exceeding five degrees (except at the crossing of ravines and streams), where, by moderate filling and bridging, the declination of the road may be preserved within that limit."

NO. 7 June SESSION, 1907.

Order to view bridge in
Cilly Ravine

Viewers.

h. A. O'Brien
Peter Robinson, Jr.
Daniel McLaughlin

Clerk 90 cts.

Stall

No. 7 June Sessions, 1907, R.S.
In the Court of Quarter Sessions
of Cambria County, Pa.

In Re Order to View
site for Bridge across
stream between the
property of Joseph Rainey
and the P. R. R. Crossing,
on Church Street, in
the Borough of Lully

Report of Viewers

Now, Dec. 6, 1907, we
believe that the
within proposed
bridge is necessary
and that it would be
too expensive for the
borough of Lully, to
build and accordingly
recommend that the
county pay half the
expense

H. J. Booth (Foreman)

Filed 5 Sept 1907

Now, Dec. 6, 1907, the within
finding and recommendation of
the Grand Jury Concurred in
and approved.
By the Court

THOMAS J. ITELL,
ATTORNEY AT LAW,
JOHNSTOWN, PA.

IN THE COURT OF QUARTER SESSIONS OF CAMBRIA COUNTY, PA.

To the Honorable Francis J. O'Connor, President Judge of the said Court:--

The petition of the undersigned citizens and taxable inhabitants of the Borough of Lilly in the said County, respectfully represents; That there is great need for the erection of a permanent bridge on Church Street in the said borough ^{across the stream} between the property of Joseph Rainey and the Pennsylvania Railroad Crossing, and that the erection of a suitable bridge of a permanent character at the place mentioned, would require more expense than it is reasonable that the Borough of Lilly should bear; they therefore respectfully pray your Honorable Court to appoint viewers to view the sight of proposed bridge and report to the next Term of Court; and they will ever pray, etc:.....

- | | |
|-----------------------|--------------------|
| 1 Blair Short | 17 Marshall Murray |
| 2 William Sweeney | 18 Joseph Rainey |
| 3 John Leonard | 19 Dr. F. P. Press |
| 4 Simon Leonard | 20 M. K. Piper |
| 5 William O'Neil | J. A. A. A. |
| 6 Wm. D. D. | E. J. Hughes |
| 7 Chas. Stitt | J. R. Sweeney |
| 8 James Smith | R. B. B. |
| 9 John A. Leap | E. H. Brown |
| 10 C. B. H. | John E. Lowery |
| 11 Wilford L. McGough | Edward Edwards |
| 12 Andrew D. | Immael |
| 13 J. Ryan | J. J. Moyer |
| 14 John M. M. | L. M. Sanderson |
| 15 Edw. Sweeney | J. A. A. |
| 16 M. M. | R. B. B. |
| 17 J. C. George | C. M. G. |

COUNTY OF CAMBRIA | SS.

Blair Short and William
Sweeney, two of the above mentioned petitioners being
duly sworn according to law, say that the statements of fact set
forth in the above and foregoing petition are true, as they verily
believe, and that the signatures to the said petition are those
of citizens and taxable inhabitants of the said Borough of Lilly.

Blair Short,
William Sweeney

Sworn and subscribed to before me this 24th day of May 1907.

C. M. Gougeon J.P.

My commission expires first Monday May 1909

Chesham, Pa., May 25th 1907,
Notice of the intended presentation of this
petition accepted for the County Com-
missioners,

J. R. Seaman
Clerk.

No. 7, JUNIOR Session, 1907, R. B.
of the County of Chester
Cambria County, Pa.

Petition of
Citizens and taxable inhabitants
of the Ward of Little for and from
County in Building Bridge
over Church Street, across
the stream between property of
Jos. Rainey and P. R. R. Crossing.

Read June 3, 1907, the within pre-
scribed, read and presented in open
Court, and C. H. Overell,
Attorney, and Peter Robinson Jr.,
and David M. Hughes, appointed
counsel, to report that next term
By the Court

Filed 3 June 1907,

Thomas S. Still