

Plan of the
PROPOSED PUBLIC ROAD IN
SUSQUEHANNA TOWNSHIP,
CAMBRIA COUNTY, PA.

Scale: 1 inch = 200 feet. Viewed Feb. 15, 1900.
 J. Leard Elder
 County Surveyor,

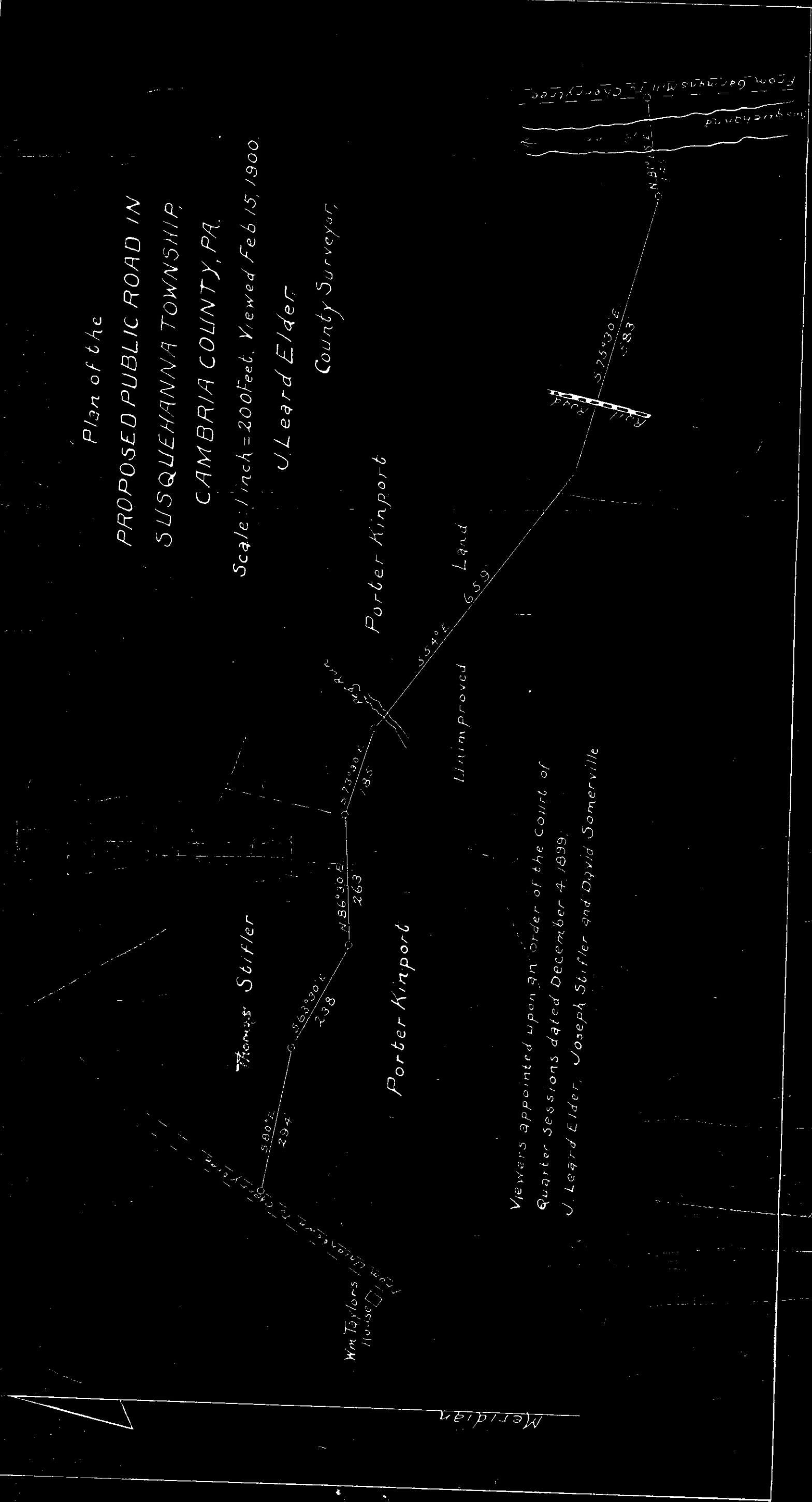

Viewers appointed upon an order of the Court of
 Quarter Sessions dated December 4, 1899:
 J. Leard Elder, Joseph Stifler and David Somerville

R. N# 1 - Dec 1899

Rot. Microfilmed

To the Honorable A. V. Barker President Judge
of the Court of Quarter Sessions of Cambria County
Pennsylvania We the undersigned viewers
appointed by the aforesaid order respectfully
report that after giving notice as required
by law and J. L. Elder Surveyor and Jos
Stifter and David Dummerville viewers having
all been first solemnly sworn or affirmed
to perform our duties according to law

We in pursuance of said order have viewed
and laid out a public road and do return
for public use the following public road
to wit - Beginning in the Township road
leading from Union Town to Cherry Tree at a point
Eighteen rods North of the residence of William
Taylor in the Township of Susquehanna Thence
South eighty degrees East two hundred and twenty four
feet thence South sixty three and one half degrees East
two hundred and thirty eight feet thence North eighty
six and one half degrees East two hundred and fifty
three feet thence South seventy three and one half degrees
East one hundred and eighty five feet thence South fifty
four degrees East one hundred and fifty nine
feet thence South seventy five and one half degrees
East five hundred and eighty three feet thence North
Eighty one and one fourth degrees East one hundred
and forty five feet to the Township road
leading from Gamans Mills to Cherry Tree
at a point opposite the residence of Mrs
Martha Byrns in said Township of Susquehanna
The road passes through Thomas Stifter and

Porter Kinports land no damages claimed
said road as afore said laid out
we are of the opinion is necessary for
a public road and recommend the same
a plot or draft thereof is herewith
attached and made part of this report
Witness our hands this 28th day of
February 1900 J. L. Elders

God bless Stiffler
David Somerville

J. L. Elders 2 days	8.00
" " 27 miles	2.70
Joseph Stiffler 1 day	2.00
" " 1 mile	.10
David Somerville 1 day	2.00
" " 1 mile	.10
Phillip H. Stiffler chairman	1.50
James Somerville "	1.50
	17.90

ROAD NOTICE.

Notice is hereby given that the viewers appointed by the Court of Quarter Sessions to view the ground for a Road beginning in the Township Road leading from Wrighttown to Cherry Tree at a point 18 rods North of the residence of Wm Taylor in the Township of Susquehanna and ending in a Township Road leading from Gammans Mills to Cherry Tree at a point opposite the residence of Mrs Martha Byers in said Township

will meet at the house of Wm Taylor in the township of Susquehanna aforesaid, on the 15th day of Feb'y 1900 ~~1899~~, at 12 o'clock for the purpose of viewing said ground.

Feb'y 3, 1900 ~~1899~~

J. L. Claus
Jos. Stiffel
David Somerville

Viewers.

Feb. 1, 1900 Served the work notice on

Arthur W. [unclear] [unclear] [unclear] [unclear]
Supervisor of Susquehanna Township by hand-
ing to each of them a copy thereof

ROAD NOTICE.

Notice is hereby given that the viewers appointed by the Court of Quarter Sessions to view the ground for a Road beginning in a Township Road leading from Uniontown to Cherry Tree at a point 18 rods North of the residence of Mrs Taylor in Susquehanna Township and ending in a Township Road leading from Gorman's Mills to Cherry Tree at a point opposite the residence of Mrs Martha Bryers in said Township

will meet at the house of Mrs Taylor in the township of Susquehanna aforesaid, on the 15th day of Feb 1900, at _____ o'clock for the purpose of viewing said ground.

Feb. 3, 1900 — 189.

J. L. Elder
Jos. Stiffler
David Homewille

Viewers.

Served the within notice on the Commissioners
of Cambria County by handing them a copy
thereof Feb'y 10th 1900

J. Leard Elder

COMMONWEALTH OF PENNSYLVANIA. }
COUNTY OF GAMBRIA, } SS:

At a Court of Quarter Sessions of the Peace of the County of Cambria held at Ebensburg in the said County, on the fourth day of December A. D. 1899, before the Honorable Judge of the said Court: Upon the petition of divers inhabitants of the Township of Susquehanna, in the said County, setting forth that they labor under inconvenience for want of a public road or highway, ~~to lead from~~ beginning in the Township Road leading from Union Town to Cherry Tree, at a point Eighteen rods North of the residence of William Taylor in the said Township of Susquehanna and ending in a Township Road leading from Garman's Mill to Cherry Tree at a point opposite the residence of Mrs Martha Byers in said Township of Susquehanna

and therefore praying the Court to appoint proper persons to — view and lay out the same according to law. The Court upon due consideration had of the premises, do order and appoint

J. L. Elder SURVEYOR, and John Stifler and David Somerville

VIEWERS, to — view the ground proposed for said road, and if they — view the same, and shall agree that there is occasion for such road, they shall proceed to lay out the same, having respect to the shortest distance and the best ground for a road, and in such manner as shall do the least injury to private property, and also be, as far as practicable, agreeable to the desires of the petitioners, and that they make a report of their proceedings to the next Court of Quarter Sessions to be held for said County, stating particularly whether they judge the same necessary for a public or private road, together with a plot or draft thereof, and the courses and distances, and references to the improvements through which it may pass.

BY THE COURT.

ATTEST:

S. W. Davis Clerk.

NOTE.—"It shall be the duty of all persons appointed in the several counties of this Commonwealth to view and review any public or private road or bridge, if they shall decide in favor of locating said road or bridge, to endeavor to procure from the person or persons over whose land such location may be made releases from all claims for damages that might arise from the opening of such road or the building of such bridge; and in every case where said viewers shall fail to procure such releases, and it shall appear to them that any damages will be sustained, it shall be their duty to assess the damages and make report thereof signed by a majority of their number, and return the same, together with all releases obtained, to the Court of Quarter Sessions, and the damages so assessed shall be conclusive, or may be subject to appeal, review or modification, as may be provided by existing laws in the different counties of this Commonwealth."

"The persons appointed as aforesaid shall view such ground, and if they shall agree that there is occasion for a road, they shall proceed to lay out the same, having respect to the shortest distance, and the best ground for a road, and in such manner as shall do the least injury to private property, and also be, as far as practicable, agreeable to the desire of the petitioners."

"The viewers, as aforesaid, shall make report, at the next term of said Court, and in the said report shall state particularly: first, who of them were present at the view; second, whether they were severally sworn or affirmed; third, whether the road desired be necessary for a public or private road; they shall also annex and return to the Court a plot or draft thereof, stating the courses and distances, and noting briefly the improvements through which it may pass; and, whenever practicable, the viewers shall lay out the said roads at an elevation not exceeding five degrees (except at the crossing of ravines and streams,) where, by moderate filling and bridging, the declination of the road may be preserved within that limit."

No. 1, December Session, 1899.

ORDER TO — VIEW the ground
for a Road beginning in
the Turf Road leading from
Union Town to Cherry-
Tree and ending in —
Turf Road leading from
Cyanams' Hills to Cherry-

Report of Viewers
Filed 5 Mar 1900

J. L. Elder
Joe Stifler
David Somerville
Viewers

CLERK DAVIS — 90 CTS.

EDL

Apr. 23^d 1900 approved and bracket fixed at 30 feet
Per the Court
15 August 1900 Confirmed
S. W. Davis Clk

David Semerille
Joseph Stuffle
J. L. Elder

To the Honorable, A.V. Barker, Judge of the Court of Quarter Sessions of Cambria County:

The petition of the undersigned, inhabitants of Susquehanna Township, in said county, respectfully represents:

That they labor under great inconvenience for want of a public road or highway beginning in the Township Road leading from Union Town to Cherry Tree, at a point ^{Eighteen} ~~five~~ rods North of the residence of William Taylor in the said Township of Susquehannah and ending in a Township Road leading from Garmans' Mills to Cherry Tree at a point opposite the residence of Mrs. *Martha* Byers in said Township of Susquehannah.

The petitioners therefore pray the court to appoint three persons qualified according to law to view the ground appraised for such road and if they see occasion, lay out the same and make report of their proceedings to the next term of this court.

And they will, every pray, &c.

NAMES

NAMES

J. E. Lloyd
Frank Johns
Daniel Braughler
S. W. Goodrichman
Israel Seare

J. M. Bate
James Ashcraft
H. A. Lackard
John R. Baker

Willie W. Adams
Wm Taylor
J. Taylor

Adam Bowers
D. W. Lloyd
Grant Bowers

Elias Stiffler
G. P. Bate

George Stiffler
J. L. House

Pet of Road

Suzuehama *etc*

No. 1 Dec. Sessions, 1899 R19

Petition of Inhabitants of
Susquehanna Twp. for the
Appointment of viewers to
view and lay out a road
beginning in the Turnpike Road
leading from Union town to
Cherry Tree at a point 18 rods
North of the residence of Wm Taylor
and ending in a top Road leading
from German Mills to Cherry
Tree opposite the residence of
Mrs. Martha Beyer.

Dec 4 Dec 1899

Dec. 4th 1899 petition
read out J. L. Eder

Jos. Shifler and
David Jennelle
appointed viewers
By the Court.

