

We the grand jury in consequence
of the heavy loss to the county by
the recent flood, recommend
that the borough of Lilly stand
the whole expense of building
the bridge asked for, where
grant street crosses the con-
emaugh creek in that borough

Emery West
Foreman

Commonwealth of Pennsylvania,
County of Cumberland } SS.

At a court of Quarter Sessions of the Peace of the County of Cumberland
held at Ellensburg in the said County, on the Tenth day of
December A. D. 1888, before the Honorable the Judges of the same
court: Upon the petition of divers inhabitants of the township of Lilly
in the said county, setting forth that they labor under inconvenience for want of a
Bridge over the Cummins Creek road or highway, to lead from
at the place where Grant Street crosses said Creek in
the said Borough and that the expense of erecting
said bridge would be too burdensome upon the
inhabitants of said Borough,

and therefore praying the court to appoint proper persons to ^{the site to} view and lay out the
same according to law. The Court upon due consideration had of the premises, do
order and appoint, Augustus M. Cornell SURVEYOR,
and Thomas Leahy and William Kelly

— VIEWERS, to view the ^{site} ~~ground~~ proposed for said
Bridge road, and if they view the same, and shall agree that there is occasion for such
Bridge road, they shall proceed to lay out the same, having respect to the shortest distance
and the best ground for a road, and in such manner as shall do the least injury to
private property, and also be, as far as practicable, agreeable to the desire of the
petitioners, and that they make a report of their proceedings to the next Court
of Quarter Sessions to be held for said county, stating particularly whether they
judge the same necessary for a public or private road, together with a plot or draft
thereof, and the courses and distances, and references to the improvements through
which it may pass.

BY THE COURT.

Attest:

A. H. Macmaster
Clerk.

NOTE.—"It shall be the duty of all persons appointed in the several counties of this Commonwealth to view and review any public or private road or bridge, if they shall decide in favor of locating said road or bridge, to endeavor to procure from the persons over whose land such location may be made releases from all claims for damages that might arise from the opening of such road or the building of such bridge; and in every case where said viewers shall fail to procure such releases, and it shall appear to them that any damages will be sustained, it shall be their duty to assess the damages and make report thereof signed by a majority of their number, and return the same, together with all releases obtained, to the Court of Quarter Sessions, and the damages so assessed shall be conclusive, or may be subject to appeal, review or modification, as may be provided by existing laws in the different counties of this Commonwealth."

"The persons appointed as aforesaid shall view such ground, and if they shall agree that there is occasion for a road, they shall proceed to lay out the same, having respect to the shortest distance, and the best ground for a road, and in such manner as shall do the least injury to private property, and also be, as far as practicable, agreeable to the desire of the petitioners."

"The viewers, as aforesaid, shall make report, at the next term of said Court, and in the said report shall state particularly: first, who of them were present at the view; second, whether they were severally sworn or affirmed; third, whether the road desired be necessary for a public or private road; they shall also annex and return to the Court a plot or draft thereof, stating the courses and distances, and noting briefly the improvements, through which it may pass; and whenever practicable, the viewers shall lay out the said roads at an elevation not exceeding five degrees, (except at the crossing of ravines and streams) where, by moderate filling and bridging, the declination of the road may be preserved within that limit."

No. 4
 Dec. 1888

Order to view a road bridge
 over the Conemaugh Creek
 in the Township of Lilly.

Thomas
 Augustus W. Thomas
 Thomas Leach
 West Kelly
 To be sworn 1889

Filed 20 July 1889

Let Shaver's Key 909
 (Pub. Authority 1889)

Letted

17 Apr. 1889. Confirmed nisi
 July 1. 1889. Confirmed absolutely
 And now, Sept 2nd, 1889, referred to the Grand Jury.
 By the Court
 By the Court
 By the Court

To the Honorable R. L. Johnston, President Judge
of the Court of Quarter Sessions of Cambria County Pa.
The petition of the undersigned, citizens
of the Borough of Dilly in said County, respectfully
represents:

That a bridge is much wanted over the
Concilmaugh Creek at the place where Grant
Street crosses said Creek in the said
Borough, and that the expense of erecting
said bridge would be too burdensome upon
the inhabitants of said Borough.

Your petitioners therefore pray your Honor
to appoint proper persons to view the premises
and to take such order on the subject as
is required and directed by law.

And they will ever pray, etc.

Joshua Aurandt
Michael P. Kearney
pro R. Keeley
James Haggan
Albert George
J. A. Thompson
H. C. George

Edward Sweeney
Fred Wheldon
S. J. Conrad

No. 4 Dec. 10 1888

Petition of Burgers Town
Council and citizens
of Lilly Borough for the
appointment of viewers
to view the site for a
Bridge over Conemaugh
Creek in said Borough

And now Dec. 10th, 1888

read and

Augustine McCormell

Thomas Leady

William Kelly appointed

viewers By the Court

Filed Dec. 10, 1888,

Kittell.

To the Honorable R.L. Johnson Judge
of the court of quarter sessions to be held
in Ebersburg for the county of Cambria

We the persons appointed by order of court
to view site for a bridge over the Comemangh
Creek at the place where Grant Street crosses
said creek in the Borough of Lilly Do report
after ten days written notice of time and
place of meeting and after having been sworn
according to law and having viewed the
proposed site we found the bridge now in use
in a dangerous condition and will have to be replaced
by a new bridge and as it is necessary as
it is on the Road leading to Ebersburg and Portage
and the length of span between the abutments is
forty eight feet (48) we would recommend that an
bridge be built we are of the opinion that the
expense of the erecting said bridge would be too
burdensome upon the inhabitants of said Borough
- Witness our hands this 9th day of February 1889

A. McConnell
Wm Kelly
Thos Leakey
Dinner

Bill

A. McConnell	1 day	1 mile
Thos Leakey	1	1
Wm Kelly	1	1

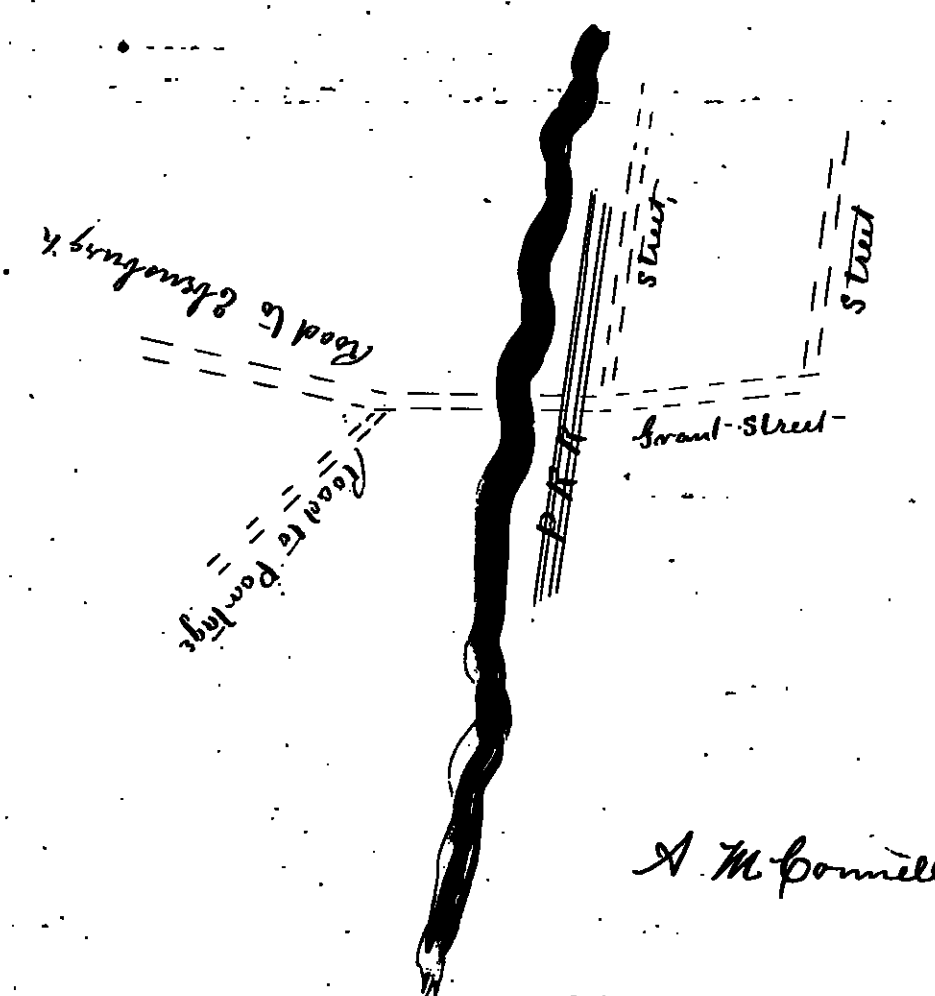

A. McConnell