

No 2 June Term 1920.

In the Court of Quarter  
Sessions of Cambria County

In re proposed Public  
Road in the Village of  
Jonestown, Borough of  
Portage, County of Cambria  
and State of Pennsylvania.

Petition for appointment of Viewers.

Filed 14 June 1920.

Decree.

And now, June 14, 1920,  
the foregoing petition hav-  
ing been presented, the same  
is read and duly considered  
and the Court appoints

A. M. Shoemaker, Adam Shuman  
and

J. D. Ritter, viewers

as within prayed for.

By the Court

Shoemaker  
Shuman  
Ritter

LAW OFFICES  
THOMAS C. EVANS  
PORTAGE, PA.

And now, June 12, 1920, service of notice of the presenting  
of the within petition on June 14, 1920 is hereby accepted for and on  
behalf of the Commissioners of Cambria County

J. B. Selman  
Asst. Clerk,

TO THE HONORABLE, THE JUDGES OF THE COURT OF QUARTER  
SESSIONS OF CAMBRIA COUNTY, STATE OF PENNSYLVANIA.

The petition of the undersigned, inhabitants of the  
Township of Portage, County of Cambria, respectfully represents:-

That your petitioners labor under great inconvenience  
for want of a public road or highway, in said Township of Portage,  
to begin at a certain point, where Penn Avenue set in the  
Village of Jamestown intersects the Public Road leading from  
Sonman to Munster, which said point of beginning is 416 feet  
distant from an intersecting Public Road leading from Portage  
to Cassandra; and extending thence, by a convenient route to a  
point of ending; Said point being the intersection of said  
Penn Avenue set with the Public Road leading from Portage to  
Cassandra, which said point of ending is 1650 feet distant  
from the Public Road leading from Sonman to Munster.

Your petitioners pray the Court, to appoint proper  
persons to view and lay out the same according to law; and they  
will ever pary, etc.

<u>NAME</u>	<u>RESIDENCE.</u>
<u>Bert P. Linnier</u>	<u>Jamestown Pa</u>
<u>Daniel P. Linnier</u>	<u>Jamestown Pa</u>
<u>Francis Seabolt</u>	<u>Jamestown Pa</u>
<u>Steve Wateko</u>	<u>Haverstown Pa</u>
<u>Jon Randall</u>	<u>Sonman Pa</u>
<u>Cashin Bairs</u>	<u>Jamestown Pa</u>
<u>Frank J. Roberts</u>	<u>Jamestown Pa</u>
<u>J. W. [unclear]</u>	
<u>M. J. [unclear]</u>	
<u>Mike [unclear]</u>	

<u>Joseph Herz Jr</u>	<u>Jamestown Pa</u>
<u>George Kohart</u>	<u>Jamestown Pa</u>
<u>Robert McKelly</u>	<u>Jamestown Pa</u>
<u>Bombardier</u>	<u>Jamestown Pa</u>
<u>Jesse Brown</u>	<u>Jamestown Pa</u>
<u>Louis George</u>	<u>Jamestown Pa</u>
<u>Thor Am, Balie</u>	<u>Jamestown</u>
<u>George Alexander</u>	<u>Jamestown Pa</u>
<u>Steve Stanko</u>	<u>Jamestown Pa</u>
<u>Andy Whiss</u>	<u>Jamestown Pa</u>
<u>P B Rhodes</u>	<u>Jamestown</u>
<u>Robert George Jr</u>	<u>Jamestown</u>
<u>Commander Stager</u>	<u>Jamestown Pa</u>
<u>Paul Dickerman</u>	<u>Jamestown</u>
<u>Michael Haselmark</u>	<u>Jamestown Pa</u>

STATE OF PENNSYLVANIA |  
 COUNTY OF CAMBRIA | SS.

Personally appeared before me a Notary Public, in and for the County of Cambria Joseph Lengyel who being duly sworn deposes and says that the statements contained in the foregoing petition are true and correct, to the best of his knowledge, information and belief.

Joseph Lengyel

Sworn and Subscribed before me this 3rd day of May, A. D. 1920.

Joseph C. Pauler  
 Justice of the Peace

MY COMMISSION EXPIRES  
 THE FIRST MONDAY IN JANUARY, 1921

ANDREW DAVIS  
TO ALBERT WYNKOOK  
ANDREW BOLAND

Supervisors of Portage Township, County of Cambria  
and State of Pennsylvania.

You are hereby notified, that the following petition  
relative to a road in the Village of Jamestown, Portage Borough,  
Pennsylvania, will be presented to the Court of Quarter Sessions  
of Cambria County on the ~~13th~~<sup>14th</sup> day of June, 1920.

" That your petitioners labor under great inconvenience  
for want of a public road or highway, in said Township of Portage,  
to begin at a certain point, where Penn Avenue in the Village of  
Jamestown intersects the Public Road leading from Sonman to  
Munster, which point of beginning is 460 feet distant from an  
intersecting Public Road leading from Portage to Cassandra; and  
extending thence, by a convenient route to a point of ending;  
Said point being the intersection of said Penn Avenue with the  
Public Road leading from Portage to Cassandra, which said point  
of ending is 1650 feet distant from the Public Road leading from  
Sonman to Munster.

Your petitioners pray the Court, to appoint proper  
persons to view and lay out the same according to law; and they  
will ever pray, etc."

THOMAS C. EVANS.

Attorney for the Petitioners.

CAMBRIA COUNTY, SS

Personally appeared before me a Notary Public, in  
and for the County of Cambria, JOSEPH LENGYEL, who being  
duly sworn, deposes and says that he personally served  
a copy of the within notice on ANDREW BOLAND, ALBERT WYNCOOP,  
AND ANDREW DAVIS, BY HANDING TO EACH OF THEM A COPY OF SAME.

*Joseph Lengyel*

Sworn and subscribed before

me, this 11'th day of June, 1920.

*Thomas C. Davis*

NOTARY PUBLIC  
BY COMMISSION EXPIRES JANUARY 22nd, 1921.

In the Court of Quarter  
Sessions of Cambria County

In re proposed Public  
Road in the Village of  
Jamestown, Township of  
Portage, County of  
Cambria, and State of  
Pennsylvania.

Filed 14 June 1920.

Bond of Petitioner

and now, June 14, 1920,  
the within Bond approved.  
By the Court

Thomas C. Evans.

KNOW ALL MEN BY THESE PRESENTS: THAT JOSEPH LENGYEL,  
STANLEY MROZEK, GEORGE ALEXANDER and  
BERT PLUMMER, all of the Township of Portage,  
County of Cambria and State of Pennsylvania, held and firmly  
bound unto Commonwealth of Pennsylvania, in the sum of  
One Hundred (\$100.00) Dollars lawful money, to be paid said  
Commonwealth, to which payment  
well and truly to be made we bind ourselves, heirs, executors  
and administrators, or any of them, firmly by these presents.

SEALED with our seals. Dated this 11th day of June,  
A. D. 1920.

WHEREAS certain petitioners of the Township of Portage,  
have presented a petition to the COURT OF QUARTER SESSIONS of  
Cambria County, asking the said Court, to appoint viewers to  
view and lay out a Public Road in the Village of Jamestown,  
Township of Portage, and County of Cambria.

NOW THE CONDITION OF THIS OBLIGATION IS SUCH that if  
the said Joseph Lengyel, STANLEY MROZEK,  
GEORGE ALEXANDER and BERT PLUMMER  
shall well and faithfully pay all of the expenses and costs,  
incident to the said proceeding, and the viewing and laying out  
of said Public Road, <sup>if the Court shall so direct,</sup> then this obligation to be void, otherwise  
to be and remain in full force and virtue.

Joseph Lengyel (Seal)  
Stanley Mrozek (Seal)  
George Alexander (Seal)  
Bert Plummer (Seal)

Signed, sealed and delivered in the Presence of:

Thomas C. [Signature]  
and Joseph Lengyel

No. 1 June Term, 1920

In the Court of Quarter Sessions of Cambria County, Pennsylvania.

In re: Petition of residents of Croyle Township for appointment of viewers to lay out a road leading from South Fork Borough to State Road leading from South Fork Borough to Lambs Bridge.

P E T I T I O N

Now, June 7, 1920,

A. M. Shoemaker, C.E.,

Adam Shuman

and J. S. Ritter

are appointed viewers as prayed for within.

B. C. Co.

Filed 7 June 1920

CLARENCE E. DAVIS  
ATTORNEY-AT-LAW  
TRUST COMPANY BUILDING  
EBENSBURG, PA.

IN THE COURT OF QUARTER SESSIONS OF CAMBERIA COUNTY,  
PENNSYLVANIA.

TO THE HONORABLE JUDGES OF SAID COURT:

The petition of the undersigned, residents and citizens  
of the Township of Croyle, in said County, respectfully  
represents:

That they labor under great inconvenience for want of a  
public road to begin at a point on Wood Street in Croyle  
Township, on the division line between South Fork, Borough,  
and Croyle Township and to end at a point on the State road  
leading from the Borough of South Fork to Lamb's Bridge, a  
distance of 1500 feet <sup>from</sup> where the said State road is inter-  
sected by the division line between South Fork, Borough, and  
Croyle Township, said proposed road being approximately one  
thousand five hundred feet in length.

That sixteen families living along the proposed road,  
all of whom, together with other residents of said Township  
of Croyle, labor under great inconvenience for want of said  
proposed road. Your petitioners, therefore, pray the Court  
to appoint three persons qualified according to law, to view  
the ground proposed for such road, and if they see fit, to  
lay out the same and make report of their proceedings to the  
next term of this Court.

And they will ever pray etc.

William C. Harr

R. D. Dwyer Peck

Philip E. George

John W. Hutzel

Harry Wood

William A. Miller

John H. Link

John P. Plummer

John W. Snence

Robert Smith

Ed Buchanan

Oliver Allen

A. E. Steffen

Ray Tubbs

Philip James George, Jr.

Mrs. George Gay

Mrs. Thomas Kenner

Leslie Jones

G. T. Nilgans

Thomas Salkeld

Thomas C. Lewis

John A. Winick

Thos F Gibson

Mrs Elizabeth Powell

Geo E. Glerner

Chas Gushky

Chas. A. Reed

E. W. Linder

William Niederer

Fred Heim

Michael Heim

William H. Moore

STATE OF PENNSYLVANIA :  
  : SS.  
COUNTY OF CALBRIA        :

Before me, the subscriber, a Justice of the Peace in and for said State and County, personally came John W. Spence, who being duly sworn according to law deposes and says that the facts, matters and things set forth in the above and foregoing petition are true and correct.

John W. Spence

Sworn and subscribed before me this 26<sup>th</sup>  
day of May, A. D. 1920.

Alfred Schofield  
Justice of the Peace.

My commission expires  
First Monday January 1926

TO THE TOWNSHIP SUPERVISORS OF CROYLE TOWNSHIP AND THE COUNTY  
COMMISSIONERS OF CAMBRIA COUNTY , PENNSYLVANIA.

GENTLEMEN:

You are hereby notified that an application will be made to the Court of Quarter Sessions of County of Cambria on Monday, the 7th day of June, 1920, at ten o'clock A. M., for the appointment of viewers to view the premises and report to the Court the expediency of laying out a public road to begin at a point on Wood Street in said Croyle Township, on the division line between South Fork Borough and said Croyle Township and to end at a point on the State Road leading from the Borough of South Fork to Lamb's Bridge, a distance of 1500 feet from where the said State road is intersected by the division line between South Fork Borough, and Croyle Township, said proposed road being approximately one thousand five hundred feet in length.

James E. Davis

Attorney for Petitioners.

May 24th, 1920, we hereby accept service of the above notice.

O. S. Stutzman

John G. Hice

Stephen Hadden

Township  
Supervisors  
of  
Croyle  
Township.

May 28th, 1920, I hereby accept service of the above notice for the Commissioners of Cambria County.

James W. Blaney

Clerk

NO. 1, June SESSION, 1920

Order to view \_\_\_\_\_

In re Petition of Residents  
of Croyle Township for a Road  
leading from South Fork Boro-  
ugh to State Road leading from  
South Fork Borough to Lambs  
Bridge.

SEP 15 1920 CERTIFIED

A.M. Shoemaker, C.E.

Adam Shuman

J. D. Ritter

Viewers.

Clerk

Robb. L. [unclear]

90 cts.

Filed 8 Sept. 1920

R E P O R T O F V I E W E R S .

To the Honorable, the Judge of the Court of Quarter Sessions of  
Cambria County, Pennsylvania.

We, the undersigned members of the board of viewers of Cambria County, appointed by your honorable Court, upon the attached order, and therein directed to view and determine as to the necessity for a certain piece of public road in Croyle Township, Cambria County, Pennsylvania, between the termini therein specified; respectfully report:

That having given due notice of the view and of the time and place of meeting of the viewers to the Commissioners of Cambria County and the Supervisors of the Township of Croyle by having them accept service of notices hereto attached and to the traveling public by printed hand bills posted in public and conspicuous places at and near the termini of the piece of road proposed to be viewed; and having been first duly qualified according to law to perform the duties of our appointment faithfully, impartially and to the best of our judgment and ability; we met at the time and place appointed and having gone over and carefully viewed the premises, we are of the opinion that the piece of road in question : a plot or draft of which is hereto attached and made a part of this report; is necessary for the accomodation of the public and that the prayer of the petitioners should be granted.

The piece of road viewed and petitioned for takes the following three courses and distances, from the point of beginning at the South Fork borough line, more definitely specified on the attached order and indicated on the attached draft, viz: South fifty five (55) degrees East four hundred fourteen feet, thence South thirty nine degrees thirty minutes ( $39^{\circ} 30'$ ) East seven hundred thirty eight feet and South forty six degrees forty five minutes ( $46^{\circ} 45'$ ) West one hundred ninety two feet to the termini on the State road as specified on said order of Court. The said piece of road for the whole distance

8 Sept 1920 Approved and breadth fixed at forty feet.

W. J. Lawrence

23 March 1921 Confirmed

Frank C. Robb  
Capt.

Order to Open

C. E. Lewis

Commonwealth of Pennsylvania, }  
County of Cambria. } SS.

At a Court of Quarter Sessions of the Peace of the County of Cambria held at Ebensburg, in the said County, on the Seventh day of June A. D. 1920, before the Honorable Judge of the said Court: Upon the petition of divers inhabitants of the Township of Croyle, in the said County, setting forth that they labor under inconvenience for want of a Public road or highway, to lead from a point on Wood Street in Croyle Township, on the division line between South Fork Borough and Croyle Township and to end at a point on the State Road leading from the Borough of South Fork to Lamb's Bridge a distance of 1500 feet from where the said State road is intersected by the division line between South Fork Borough, and Croyle Township, said proposed road being approximately one thousand five hundred feet in length.

That sixteen families living along said proposed road all of whom, together with other residents of said Township of Croyle labor under great inconvenience for want of said proposed road.

and therefore praying the Court to appoint proper persons to view and lay out the same according to law. The Court, upon due consideration had of the premises, do order and appoint

A. M. Shoemaker, surveyor, and

Adam Shuman and J. D. Ritter

viewers, to view the ground proposed for said road, and if they view the same, and shall agree that there is occasion for such road, they shall proceed to lay out the same, having respect to the shortest distance and the best ground for a road, and in such manner as shall do the least injury to private property, and also be as far as practicable, agreeable to the desires of the petitioners, and that they make a report of their proceedings to the next Court of Quarter Sessions to be held for said County, stating particularly whether they judge the same necessary for a public or private road, together with a plot or draft thereof, and the courses and distances; and references to the improvements through which it may pass.

By the Court.

Attest:

Frank B. Roth, Clerk.

NOTE. "It shall be the duty of all persons appointed in the several counties of th  
and review any public or private road or bridge, if they shall decide in favor of locating said road or bridge, to  
deavor to procure from the person or persons over whose land such location may be made releases from all claims  
for damages that might arise from the opening of such road or the building of such bridge; and in every case  
where said viewers shall fail to procure such releases, and it shall appear to them that any damages will be sus-  
tained, it shall be their duty to assess the damages and make report thereof signed by a majority of their number,  
and return the same, together with all releases obtained, to the Court of Quarter Sessions, and the damages so as-  
sessed shall be conclusive, or may be subject to appeal, review or modification, as may be provided by existing laws  
in the different counties of this Commonwealth."

"The persons appointed as aforesaid shall view such ground, and if they shall agree that there is occasion for  
a road, they shall proceed to lay out the same, having respect to the shortest distance, and the best ground for a  
road, and in such manner as shall do the least injury to private property, and also be, as far as practicable, agree-  
able to the desire of the petitioners."

"The viewers, as aforesaid, shall make report at the next term of said Court, and in the said report shall state  
particularly: First, who of them were present at the view, second, whether they were severally sworn or affirmed;  
third, whether the road desired be necessary for a public or private road; they shall also annex and return to the  
Court a plot or draft thereof, stating the courses and distances, and noting briefly the improvements through  
which it may pass; and, whenever practicable; the viewers shall lay out the said roads at an elevation not exceeding  
five degrees (except at the crossing of ravines and streams), where, by moderate filling and bridging, the declina-  
tion of the road may be preserved within that limit."

ALFRED  
ATTOR  
ESS

HOEMAKER  
AT-LAW  
G. PA.

Croyle 7 p.

W. M. Shoemaker  
 Lifting Order of Court \$ 90.  
 5 Days @ 7.50 37.50  
 116 miles (2 trips) 580  
 Eng. work & blue prints 18.75

---

6290

J. D. Gitter  
 1/2 Day \$ 11.25  
 82 miles 4.10

---

1534

A. Shuman  
 1/2 Day \$ 11.25  
 82 miles 4.10

---

1534

APPROVED FOR PAYMENT

Wm. H. Roberts  
2015  
COMMISSIONER

being laid out over a private or dedicated street already in use and no damages being sustained by any of the property owners none are assessed. Said piece of road passes in front of properties of Elias Link Mrs. Penrod, Elmer Noon, William Miller, John W. Spence, Leslie Jones, Daniel Hillegass, D. Hootzel, John Hootzel, Philip S. George, Mrs. \_\_\_\_\_ Bennett, M. Lauder and others.

Witness our hands this 28th. day of August, A. D., 1920.

\_\_\_\_\_  
*Adam Sherman*

\_\_\_\_\_  
*J. R. Ritter*

Viewers.

# ROAD NOTICE

Notice is hereby given that the Viewers appointed by the Court of ... Quarter .....  
Sessions ..... of Cambria County, Pa., to view and determine as to  
the necessity for a public road in Croyle Twp., said county and state;

To begin at a point on Wood Street, in Croyle Twp., on the line be-  
tween South Fork Borough and Croyle Twp.; and to end at a point on  
the State Road, leading from South Fork Boro. to Lamb's Bridge, 1500  
ft. from where the State Road is intersected by the division line  
between said township and borough:

will meet at the place of beginning, above noted, ..... in the  
Township ..... of ..... Croyle ..... aforesaid,  
on the ~~28th~~ day of August ..... 1920, at 9:30 o'clock a. m.,  
for the purpose of performing the duties of their appointment.

A. M. Shoemaker,

J. D. Ritter and

Adam Shuman,

Ebg., Pa. 8/10/20. MEX.

Viewers.

Service of the within notice is hereby accepted for the  
Commissioners of Cambria County, Pa.

8/9/20

James M. Lewis  
J. M. Lewis

# ROAD NOTICE

Notice is hereby given that the Viewers appointed by the Court of .. Quarter ..  
Sessions .. of Cambria County, Pa., to view and determine as to  
the necessity for a public road in Croyle Twp., said county and state;  
To begin at a point on Wood Street, in Croyle Twp., on the line be-  
tween South Fork Borough and Croyle Twp., and to end at a point on  
the State Road, leading from South Fork Borough to Lamb's Bridge,  
1500 feet from where the State Road is intersected by the division  
line between said township and borough:

will meet .. at the place of beginning, above noted, .. in the  
Township .. of .. Croyle .. aforesaid,  
on the 28<sup>th</sup> day of .. August .. 19.20 at .. 9:30 o'clock .. a. m.,  
for the purpose of performing the duties of their appointment.

..... A. E. Shoemaker, ..

..... J. D. Ritter and ..

..... Adam Shuman ..

Viewers.

Hbg., Pa. ... 8. / .10. / 1920.

Now Aug, 1920, Service of the within  
notice is hereby accepted by the under-  
signed Supervisors of the Township of  
Croyle, Cambria Co., Pa.

John F. Hices  
C. S. Stutzman

Supervisors

NO. 2, June SESSION, 1920

Order to view \_\_\_\_\_

In re proposed Public Road  
in the Village of Jamestown,  
Township of Portage, Cambria  
County, Pennsylvania.

A. M. Shoemaker,

Adam Shuman

J. D. Ritter

} Viewers:

Clerk Robb 90 cts.

*Filed 8 Sept. 1920*

Sept. 19.20 Approved and breadth fixed at forty feet.  
By the Court

Commonwealth of Pennsylvania, }  
County of Cambria. } SS.

At a Court of Quarter Sessions of the Peace of the County of Cambria held at Ebensburg, in the said County, on the Fourteenth day of June A. D. 1920, before the Honorable Judge of the said Court: Upon the petition of divers inhabitants of the Township of Portage, in the said County, setting forth that they labor under inconvenience for want of a Public road or highway, to ~~begin~~ begin at a certain point, where Penn Avenue in the Village of Jamestown intersects the Public road leading from Sonman to Munster, which said point of beginning is 416 feet distant from an intersecting Public Road leading from Portage to Cassandra; and extending thence, by a convenient route to a point of ending; Said point being the intersection of said Penn Avenue with the Public Road leading from Portage to Cassandra, which said point of ending is 1650 feet distant from the Public road leading from Sonman to Munster

and therefore praying the Court to appoint proper persons to view and lay out the same according to law. The Court, upon due consideration had of the premises, do order and appoint

A. M. Shoemaker, surveyor, and Adam Shuman and J. D. Ritter

viewers, to view the ground proposed for said road, and if they view the same, and shall agree that there is occasion for such road, they shall proceed to lay out the same, having respect to the shortest distance and the best ground for a road, and in such manner as shall do the least injury to private property, and also be as far as practicable, agreeable to the desires of the petitioners, and that they make a report of their proceedings to the next Court of Quarter Sessions to be held for said County, stating particularly whether they judge the same necessary for a public or private road, together with a plot or draft thereof, and the courses and distances, and references to the improvements through which it may pass.

By the Court.

Attest:

Frank L. Roth, Clerk.

NOTE. "It shall be the duty of all persons appointed in the several counties of this Commonwealth to view and review any public or private road or bridge, if they shall decide in favor of locating said road or bridge, to endeavor to procure from the person or persons over whose land such location may be made releases from all claims for damages that might arise from the opening of such road or the building of such bridge; and in every case where said viewers shall fail to procure such releases, and it shall appear to them that any damages will be sustained, it shall be their duty to assess the damages and make report thereof signed by a majority of their number, and return the same, together with all releases obtained, to the Court of Quarter Sessions, and the damages so assessed shall be conclusive, or may be subject to appeal, review or modification, as may be provided by existing laws in the different counties of this Commonwealth."

"The persons appointed as aforesaid shall view such ground, and if they shall agree that there is occasion for a road, they shall proceed to lay out the same, having respect to the shortest distance, and the best ground for a road, and in such manner as shall do the least injury to private property, and also be, as far as practicable, agreeable to the desire of the petitioners."

"The viewers, as aforesaid, shall make report at the next term of said Court, and in the said report shall state particularly: First, who of them were present at the view, second, whether they were severally sworn or affirmed; third, whether the road desired be necessary for a public or private road; they shall also annex and return to the Court a plot or draft thereof, stating the courses and distances, and noting briefly the improvements through which it may pass; and, whenever practicable, the viewers shall lay out the said roads at an elevation not exceeding five degrees (except at the crossing of ravines and streams), where, by moderate filling and bridging, the declination of the road may be preserved within that limit."



R E P O R T O F V I E W E R S .

To the Honorable, the Judges of the Court of Quarter Sessions of  
Cambria County, Pennsylvania.

We, the undersigned members of the board of viewers of Cambria County, appointed by your honorable Court, upon the attached order, and therein directed to view and determine as to the necessity for a certain piece of public road in Portage Township, said county and state, between the termini therein specified; respectfully report:

That having given due notice of the view and of the time and place of meeting of the viewers to the Commissioners of Cambria County and to the Supervisors of Portage Township by having them accept service of the notice hereto attached and to the traveling public by printed hand bills posted in public and conspicuous places at and near the termini of the piece of road proposed to be viewed; and having been first duly qualified according to law to perform the duties of our appointment faithfully, impartially and to the best of our judgment and ability; we met at the time and place appointed: J. D. Ritter not appearing; and having gone over and carefully viewed the premises, we are of the opinion that the piece of road in question: a plot or draft of which is hereto attached and made a part of this report: is not necessary for the accomodation of the traveling public and that therefore the prayer of the petitioners should not be granted.

The piece of road petitioned for takes the following courst and distance from the point of beginning designated on the attached order; viz, North eighty one (81) degrees and fifteen (15) minutes West twelve hundred eighty(1280) feet to the point of ending also definitely specified on said attached order of the Court; and as indicated on the attached draft, above referred to, and is practically parallel to and approximately midway between two other public thoroughfares, each of which are of a better grade and so located as to serve a greater portion of the local population and also the traveling public.

Witness our hands this 28th. day of August, A.D., 1920.

A. M. Shoemaker

Adam Sherman

Viewers.

# ROAD NOTICE

Notice is hereby given that the Viewers appointed by the Court of Quarter Sessions of Cambria County, Pa., to view and determine as to the necessity for a public road in Portage Twp., said county and state: To begin at a point where Penn. Ave. intersects the public road leading from Sonman to Munster; in the Village of Jamestown; and ending at a point where Penn. Ave. intersects the public road leading from Portage to Cassandra:

will meet at the place of beginning, above noted, in the Village of Jamestown aforesaid, on the 24<sup>th</sup> day of August 1920, at 9:15 o'clock a. m., for the purpose of performing the duties of their appointment.

A. M. Shoemaker,  
J. D. Ritter and  
Adam Shuman,  
Viewers.

Ebg., Pa. 8/10/20. 19..

Service of the within notice is hereby accepted for the  
Commissioners of Cambria County, Pa.

8/9/20

Jessie M. Deane  
Clerk

Now Aug. 1920 Service of within  
notice is hereby accepted by the under-  
signed supervisors of Portage Job - Cambria  
Co., Pa.

Andy Boland

NOV 20 1920

ALFRED M. SHOEMAKER  
ATTORNEY AT LAW  
EBENSBURG PA.

Postage Ins. Via

A. M. Shoemaker  
Sifting Order \$90.  
5 Days 37.50  
80 mi. (2 trips) 4.00  
Engineering work <sup>and</sup> blue prints 18.75  
\$61.15

SEE 1-15-1911

Adam Shuman  
1 Day on View 7.50  
44 miles 2.20  
\$9.70

PAID

APPROVED FOR PAYMENT  
*[Signature]*  
2-13-1911

Open Street  
or alley: designates  
of alley

Brooklyn  
Brooklyn

Line  
414 ft  
S. 55° E.  
Road

laid

out

over

S. 39° 30' E.  
Road

738 ft.  
dedicated

Row  
Row  
Row

Street

Mrs. Burnett  
5.46.45' W. 1924

M. Lander

Row

Elias Link

Mrs. Penrod

Elmer Noon

William Miller

John W. Spencer

Fitzhewer

Leslie Jones

Daniel Hillegass

Mrs. S. Kemmery

D. Hootzel

John Hootzel

Mrs. Geo. Gay

Philip George

D. Peal

H. Woods

Plot or draft showing the location of a piece of public road in Brooklyn, Bamberia Co., Pa. Placed and laid out upon an Order of the Board of Quarter Sessions of said county, dated June 19, 1920. A. M. Shoemaker, J. D. Pitter and Adam Shuman, Quincers

State

Road

South Fork Borough to Lantini Bridge

→

Row of ending being made in order of Board attached

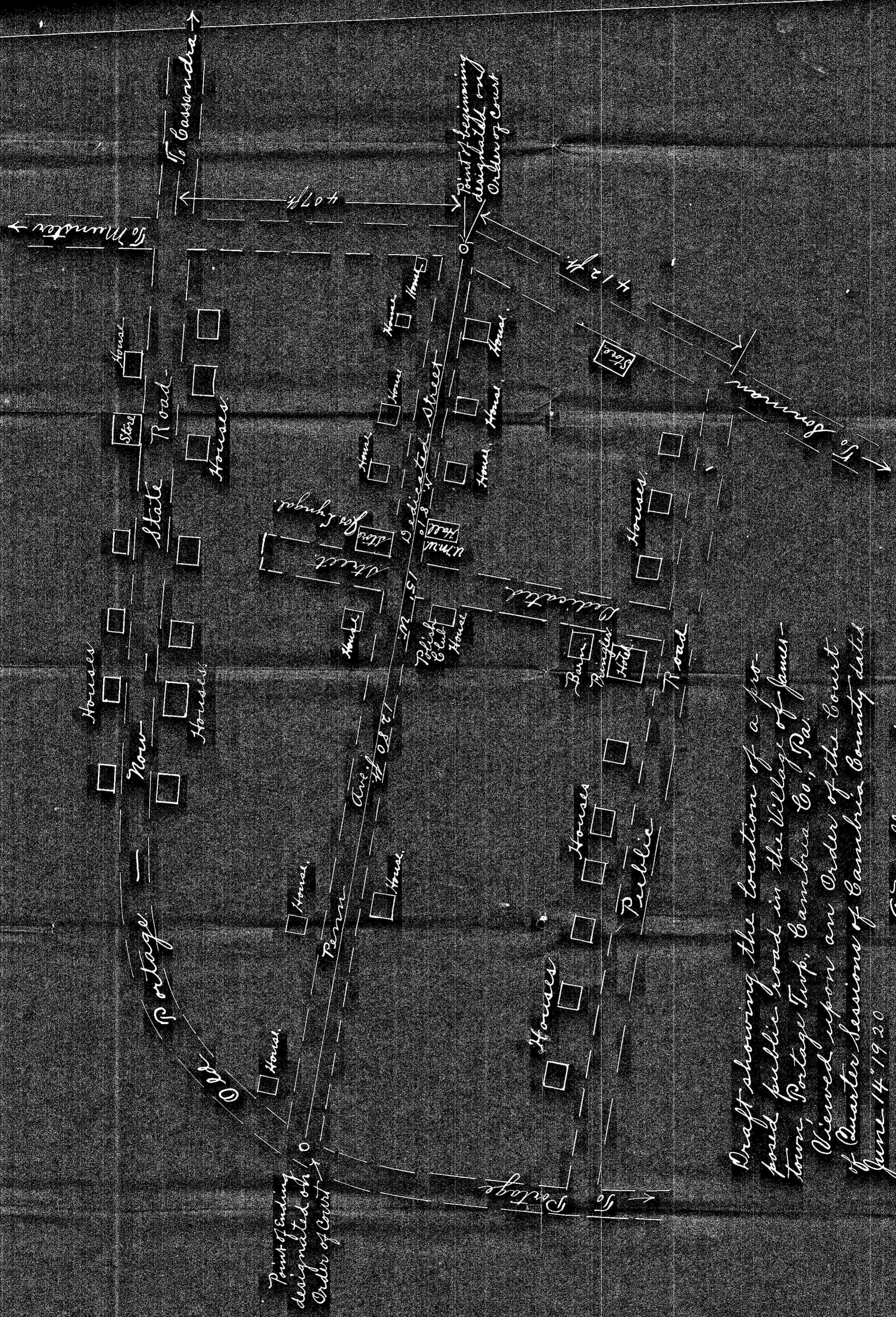

Draft showing the location of a proposed public road in the Village of James-town, Portage Twp., Cambria Co., Pa.  
 Viewed upon an Order of the Court of Quarter Sessions of Cambria County dated June 14, 1920

A. M. Shomaker  
 Adam Shuman  
 Viewed



Pat. Microfilmed

RD# 1

June 1920